

FA
720.5
N4193
v. 7
No. 11-12

Reed Zimmerman Lib.

NOV 15 1965

new mexico architecture



●● IDEALITE

lightweight aggregate
concrete increased
usable area by 10% ●●

*Piel, Slater, Small & Spenset
architect*

The continuous ramp parking garage for the Western Farm Bureau Life Insurance building in Denver utilizes 63-foot clear spans of post-tensioned Idealite lightweight concrete. The clear spans and the efficiency of the continuous ramp facilitate customer self-parking and provides space for 251 cars in 77,000 square feet. If you are considering the construction of a parking garage, warehouse, apartment, office building or other such structure, investigate the advantages of Idealite concrete. It's strong, yet light in weight; 30% less than normal concrete. It offers superior insulating and acoustical properties, as well as low moisture absorption and low shrinkage.



IDEALITE

*Producers of Idealite Lightweight Aggregate
for Concrete and Concrete Products*

806 Boston Building • Phone 534-5144
Denver, Colorado 80202

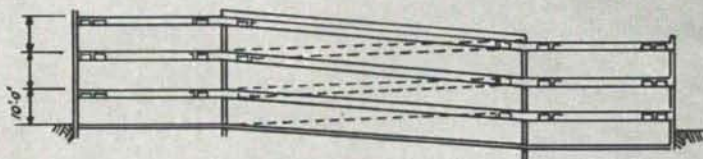
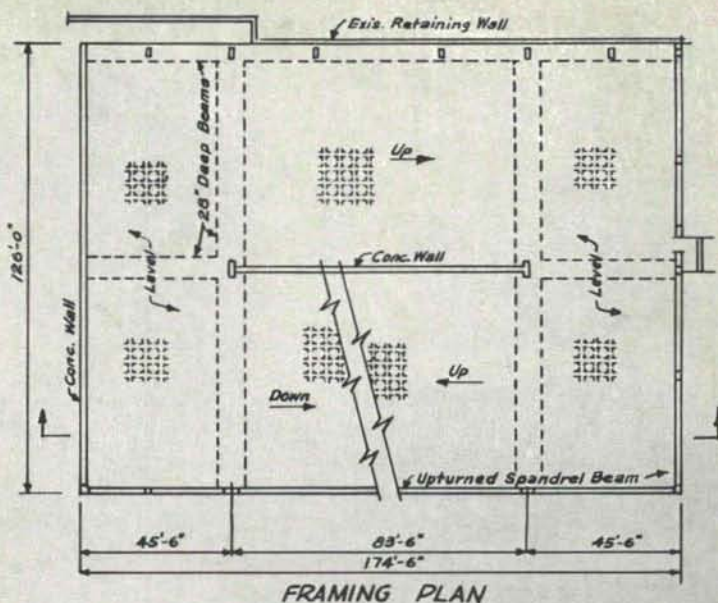

ANDERSEN, KOERWITZ & HAWES, STRUCTURAL ENGINEER



nma

vol. 7 • nos. 11 and 12 • nov.-dec. 1965 • new mexico architecture

New Mexico Architecture 2nd Photography Contest 7

The New Mexico State Capitol—David Gebhard 9

News 11

Albuquerque-Downtown—Charles W. Quinlan 13

Department of Architecture, U.N.M.,—New Chairman 21

(Cover — Albuquerque City Hall — Jean Rodgers Oliver — Photographer)

— Official Publication of the New Mexico Society of Architects, A. I. A. —

Society Officers

President—Bradley P. Kidder
Vice-President—Hugh Rowland
Secretary-Treasurer—Robert Mallory
Director—Joe F. Boehning
Director—Beryl Durham
Director—John McHugh
Director—Don Oschwald
Director—John B. Reed
Director—W. Kern Smith

Publications Committee

Bainbridge Bunting)
John P. Conran) Co-Editors
Jean Rodgers Oliver—Photographer
W. M. Brittelle, Sr.—Advertising
Van Dorn Hooker—Circulation
Jason P. Moore
John B. Reed
Robert G. Mallory
Richard S. Clark
Charles E. Nolan, Jr.



Structural Steel

for New Mexico's thriving
building industry since 1942

Miller & Smith
Mfg. Co., Inc.

500 Phoenix Ave. N.W. Station B, Box 6007

Albuquerque, New Mexico

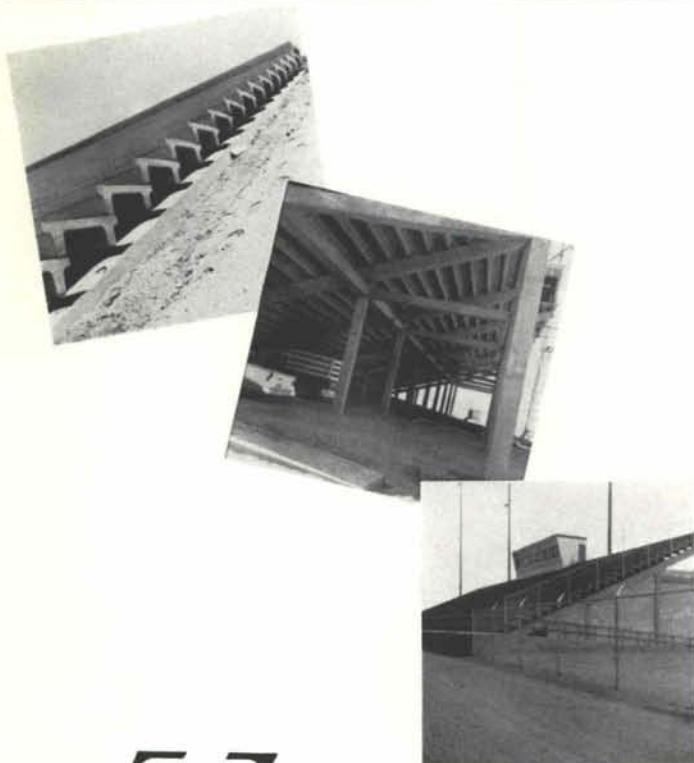

PRE-STRESSED CONCRETE

from
TOP
to
BOTTOM

"THREE CHEERS"
for
PRE-STRESSED
CONCRETE



HYDRO CONDUIT CORPORATION

2800 SECOND ST., SW • ALBUQUERQUE, NEW MEXICO



Showrooms & Sales Offices

CREGO BLOCK CO., Inc.

Manufacturers of the finest Autoclave Blocks in New Mexico

Meeting or surpassing ASTM minimum code requirements

6026 Second, N.W.

Albuquerque
344-3475 (505)

New Mexico
87107

ARCHITECTS — BUILDERS

Visit Our Showrooms—displaying such products as;

- **Normal**, all sizes of Scoria Blocks
- **"SLUMPROK"** Double faced hollowcore only by CREGO. Soft shadows & highlights, in 4 colors.
- **SPECIAL**, Lightweight (25#) Scoria Block with 1" sidewalls — extra large cores — only by CREGO —See Photo
- **SHADOW, Sculptured & Sun Screen** blocks in all sizes and varieties
- Miscellaneous materials of interest

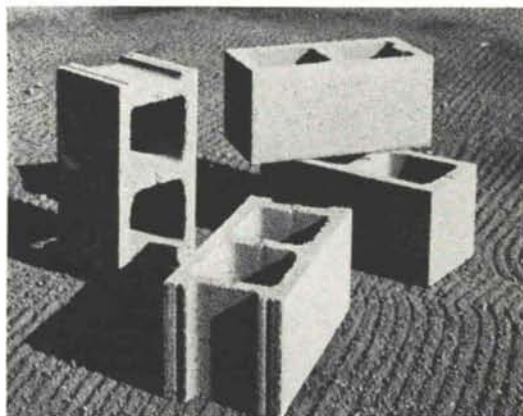

FOR
EFFICIENT
TWO-WAY
TRAFFIC

THROUGH
A SINGLE
DOORWAY—

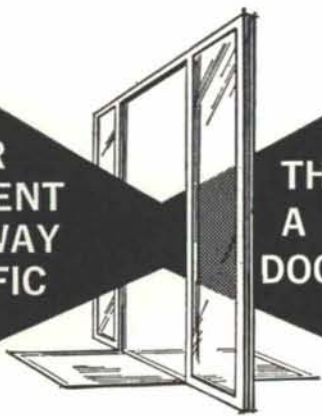

Stanley also offers a complete line of famous MAGIC-DOOR® operators (pneumatic, hydraulic, electric), controls and accessories for doors that swing, slide or fold.

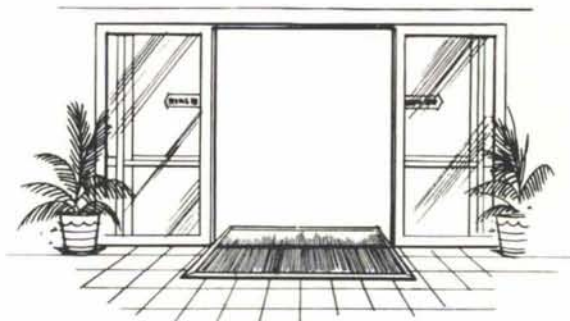

AN UNOBSTRUCTED OPENING
FROM 2½' to 8' WIDE

STOCKING DISTRIBUTOR AND
FACTORY TRAINED INSTALLERS

WELCH-ERWIN CORPORATION

4019 C EDITH BLVD. N.E.
ALBUQUERQUE, NEW MEXICO

P. O. BOX 681

PHONE 344-3547

STANLEY® Automatic Sliding Entrances

Series 1000 AUTO-SLIDE: Complete with doors that swing open for emergency use.

Series 5000 SLIMLINE: Compact, narrow-line construction; especially suitable for small shops.

- Savings in floor space.
- Low initial and low maintenance costs.
- No safety carpets needed.
- Two-way traffic through a single door.
- Positive one-way traffic possible using one operating carpet.
- Aesthetically clean. No guard rails or barrier ropes required.
- Sliding doors avoid wind or stack problems.
- Reduced costs of air-conditioning and heating.
- Sliding motion of door is safer. Can be operated manually.



This attractive home is built with 8 x 4 x 16 Atlas White Mission Masonry

Atlas Mission Masonry is well adapted to building in the Spanish architectural style so popular in the Southwest. Painting is not required; available in various shades.

Don't settle for a substitute . . . build with Atlas Mission Masonry.

Call collect for information and prices to
Walter Frank, 772-1451, El Paso.



BUILDING PRODUCTS CO.

200 N. GLENWOOD • EL PASO, TEXAS 79905



A new world in which to work

The ACTION OFFICE

Photo shows a sitdown worker's grouping

**Distributor of
Herman Miller Furniture**

Visit our display rooms
at
509 Second Street, NW
Albuquerque, New Mexico
(505) 247-0263

Furniture groupings for the standup worker, the sitdown worker, the straddler or the percher are assembled for your edification.



Researched and developed
by Robert Probst, Director of
Herman Miller's Research Division.



Design by George Nelson