

# new mexico architecture

march-april 1974

50¢

1974 Roster  
New Mexico Society  
of Architects — AIA  
&  
New Mexico Members  
of  
A. I. D. — N. S. I. D.

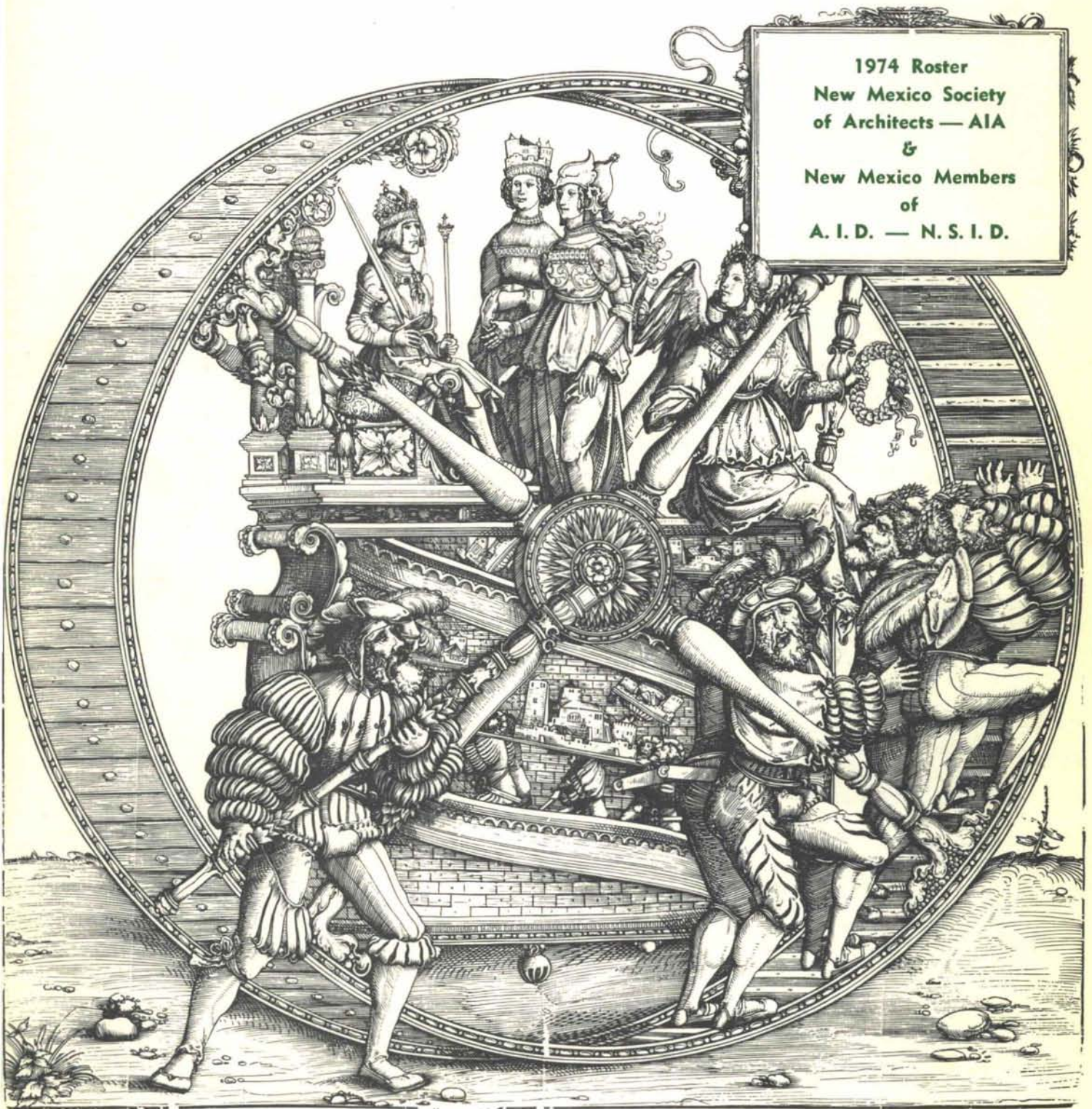

Walls with an architect's  
personal stamp—  
from the colorful  
new world of customized masonry

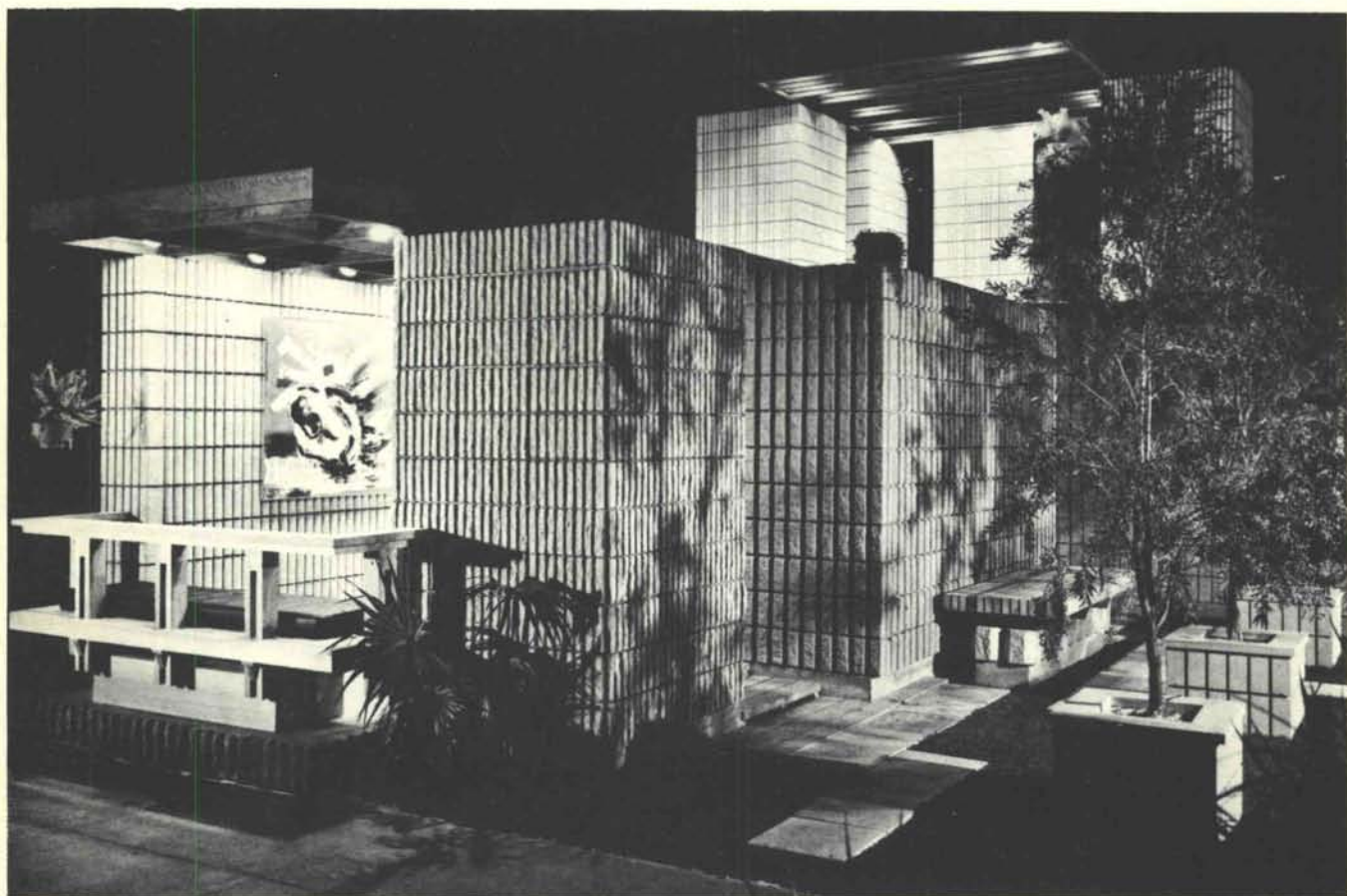

Architects no longer are limited to selecting their block units from a catalog. With the introduction of customized concrete masonry, the architect can design his own units. Customized masonry provides for the architect the ability to use block, long famed for its economy, fire safety, insulating qualities and local availability, in a way that is as personal as his own signature.

**crego block co., inc.**

6026 second st. n.w.  
albuquerque, new mexico

344-3475  
87107



vol. 16 nos. 3 & 4

# nma

mar-april 1974 • new mexico architecture

## IN THIS ISSUE:

A tale of years and bureaucracy—two words which seem synonymous, at least in this instance. James Murray III of Hobbs has won over both. But see Page 17.

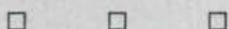

For the first time, this year's roster includes both the members of the American Institute of Interior Designers and the National Society of Interior Designers.

Negotiations are, hopefully, in the final stages, which will result in the merger of these two organizations into a single, and, therefore stronger, professional voice. AID and NSID will become the American Society of Interior Designers with over 5,000 professional members in these 50 states. From a stronger base and with increased vitality, it is expected that the entire interior design profession will be represented by a single, perhaps more ASID, voice.

JPC

## NMA News 9

AIA Stand on Timber and Mining  
New Mexico Arts Commission Awards  
Solar Energy Building for NMSU  
Ghost Town Conference—The Gavin House

## 1974 Roster—New Mexico Society of Architects 13

## 1974 Roster—New Mexico Members— American Institute of Interior Designers— National Society of Interior Designers 16

## A Korean Family Comes To The U. S. 17

## Index To Advertisers 26

(Cover—from *THE TRIUMPH OF MAXIMILIAN I*—Burgkmair)



—Official Publication of the New Mexico Society of Architects, A. I. A.—

## Society Officers

President—John P. Conron  
Vice President—Richard Waggoner  
Secretary-Treasurer—Robert C. Campbell  
Director—Jess T. Holmes, Jr.  
Director—W. Kern Smith  
Director—Ted C. Luna  
Director—Kenneth S. Clark, FAIA  
Director—Charles E. Nolan, Jr.  
Director—Bill J. Waters  
Director—Van Dorn Hooker

## Commission for NMA

John P. Conron—Editor  
Bainbridge Bunting—Editorial Consultant  
Robert G. Mallory—Advertising  
Mildred Brittelle—Financial  
Secretary, Circulation  
John W. McHugh  
James M. Murray, III  
Sam Pool



### TJ A SOLUTION TO VARYING ROOF SLOPES

Not only was it a solution to varying roof slopes but the builder was pleased with the easy and quick installation of the roof system.

B. J. Stratton of Forest Currell Lumber and Block Company puts it this way:

"Varying roof slopes and spans posed a problem but we used the TRUS JOIST L-Series, spanning between the steel bents, to solve it and were very pleased with the savings in time and labor."

Time and labor-saving versatility.

Always versatility.

Building: Security Bank of Ruidoso  
Architect: Kern Smith, Durham & Assoc.  
Builder: Forest Currell Lumber Company

Geo. B. McGill Co., Inc.

3520 Pan American N. E.  
Albuquerque 87107  
Phone 505/345-4501



McGill - Stephens, Inc.

5407 N. Mesa  
El Paso, Texas 79912  
Phone 915/584-6541

## Congoleum®

FINE FLOORS



## PEERLESS™

**CUSHIONED VINYL FLOORS.** THE ULTIMATE IN CUSTOM FLOORS FOR COMMERCIAL INSTALLATION. THE WHITE SHIELD BACK ALLOWS INSTALLATION ON OR BELOW GRADE.

ASK TO SEE THE WIDE SELECTION OF BEAUTIFUL PATTERNS IN PEERLESS CUSHIONED VINYL SHEET GOODS. EXTRA RUGGED, YET SO BEAUTIFUL.



312 INDUSTRIAL AVENUE, N. E.  
ALBUQUERQUE, N. M. P. O. BOX 25111, 87125  
PHONE 344-2317

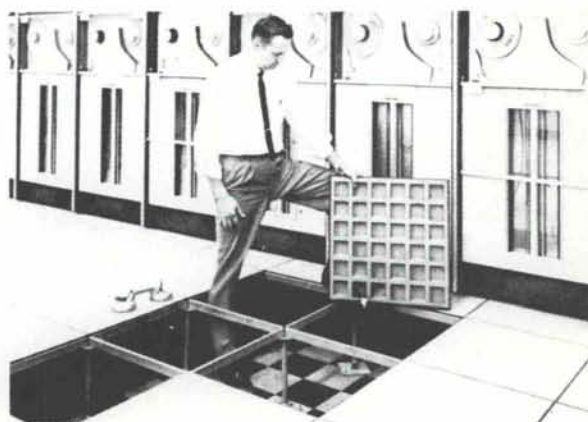

### THE INFINITE ACCESS FLOOR

The sensible answer to the problem of underfloor, accessibility for cables - heating, cooling, conduit, piping, conveyors, etc.

The Tate Floor System, as installed by New Mexico Marble & Tile Co. offers the advantage of: The high strength of steel, interchangeable floor panels, fire resistance, low cost, lateral stability, permanent floor level, cut-out flexibility, dimensional stability, unaffected by temperature or humidity, owners choice of floor covering.



**COOK'S BUILDING SPECIALTIES**

414 SECOND ST., S.W. 243-5541  
ALBUQUERQUE, NEW MEXICO • P.O. BOX 834, 87103

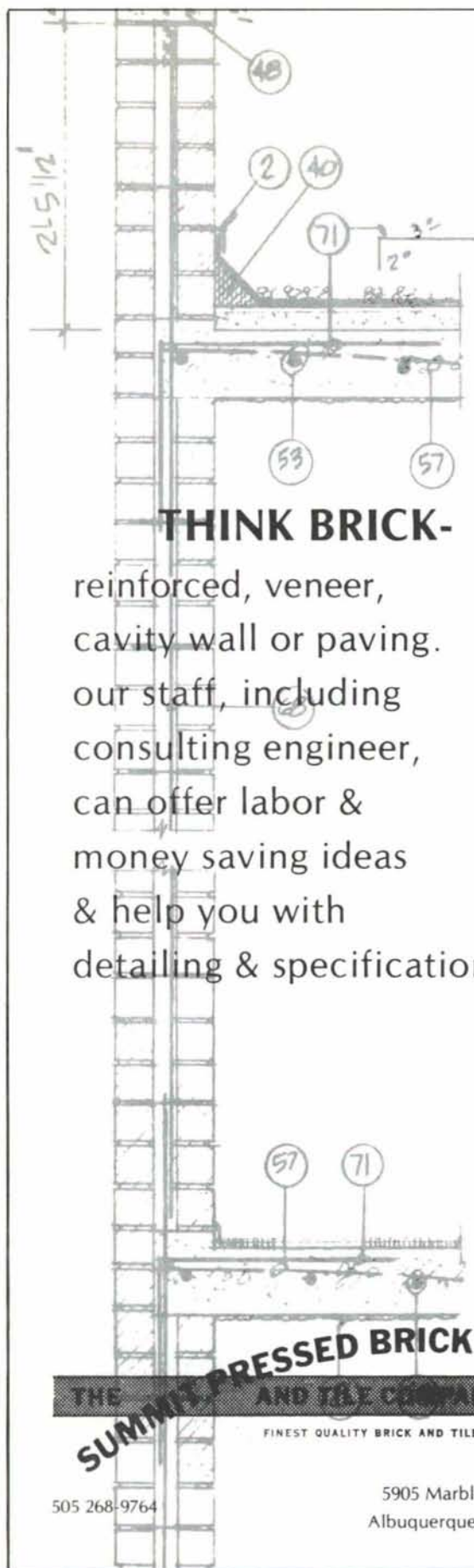

## THINK BRICK-

reinforced, veneer,  
cavity wall or paving.  
our staff, including  
consulting engineer,  
can offer labor &  
money saving ideas  
& help you with  
detailing & specifications.

**SUMMIT PRESSED BRICK**

THE SUMMIT PRESSED BRICK AND TILE COMPANY

FINEST QUALITY BRICK AND TILE

505 268-9764

5905 Marble N.E.  
Albuquerque N.M.

### THREE NEW CONTRACT FORMS AVAILABLE FROM NMSA FORM SERVICE

Three new AIA standard agreement forms have been completed and are now available.

AIA form B801 is entirely new. It is an owner-construction manager contract. Use of the form is especially recommended for architects who provide construction management services.

AIA B141 is an architect-owner contract. It replaces three earlier documents, B131, B231, and B331.

B141 is an advance over the previous forms because it includes four methods of compensation—including for the first time a fixed-fee method—in one form.

Among the other changes in the document are three of special significance:

Section 3.5.1 provides for adjustment of any fixed limit of construction cost when bidding or negotiation is delayed.

Section 6.1.3 provides that the architect will be paid automatically when the construction period runs beyond the date established in the construction contract.

Section 11.1 prohibits consolidation and joinder in arbitration without the architect's consent.

AIA form C141, an architect-engineer contract, replaces previous forms C131, C231, and C331. Its changes parallel those in B141. Of particular importance is Article 6 on the payment of engineers.

#### AIA FORM SERVICE

P. O. BOX 7415

ALBUQUERQUE, N. M. 87104



## You Can't Burn Natural Gas!

In fact, a burning match would "drown" in a 100% natural gas atmosphere. Natural gas contains no oxygen, so an atmosphere with less than 4% or more than 14% of gas is incapable of burning. To support combustion, you have to mix about 10 parts of air to one of gas. Then—and only then—can you harvest the blue flame which does so many modern jobs so dependably and so efficiently for such a low cost.

Natural gas under control is completely harmless. And since it's lighter than air, it usually can't collect in one spot in a moving atmosphere. Moreover, the air in an average house changes one and one-half times each hour. A professional study in Washington, D.C.—where the ratio of electric meters to gas meters was 1.1 to 1—showed the ratio of electrical fires was 26 to 1. The ratios in your own community are probably quite similar. Natural gas has an enviable safety record, so remember:

If you want the job done right... do it with gas.

**SOUTHERN UNION GAS COMPANY**

# FOR WAREHOUSE COMPLEXES . . .

*Concrete Construction Makes Sense.*



The new Princeton Park of Commerce Warehouse and Office complex in Albuquerque was erected with precast-prestressed concrete twin tee walls for maximum strength and fire resistance. The twin buildings are 80' x 480' each and together contain 77,000 square feet of office and warehouse space.

Owners—Max Mansur - Neal Wiggans

ENGINEER—MacCormack & Burns  
CONTRACTOR—Weaver Construction Co.

**PRESTRESSED T-T  
CONCRETE PRODUCTS, INC.**

1304 Menaul Blvd., N. E., Albuquerque, N. M. 87105 (505) 345-5671

**MONO THERM**

SPRAY INSULATION-  
ACOUSTICAL SYSTEM  
for its . . .

**Keers, Inc.**

3323 STANFORD, N. E.  
ALBUQUERQUE, NEW MEXICO



HIGH THERMAL  
RATING

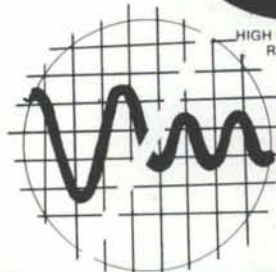

ACOUSTICAL  
EXCELLENCE



CONDENSATION  
CONTROL



FIRE RETARDANT



ARCHITECTURAL BEAUTY



EASE OF APPLICATION



**Ponding causes a whole deluge of problems. Zonolite roof deck systems turn them off.**

Zonolite® has roof decks for everything. For the slope-to-drains. For hurricanes. For protection against fire. And for insulation.

Roof deck systems certified by Zonolite. Available everywhere in the U. S. and Canada. Installed by approved applicators each and every month of the year.

Just talk to your local Zonolite representative. He'll be pleased to consult with you and come up with a recommendation that will satisfy all your design requirements.

Want to correct a roof deck problem. Or better yet, prevent one in the first place?

Say the word!

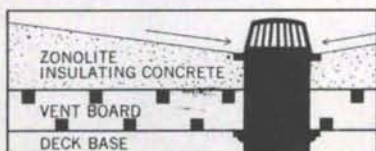

**ZONOLITE**

Southwest Vermiculite Co.  
5119 Edith Blvd. N.E.  
Albuquerque, New Mexico 87107

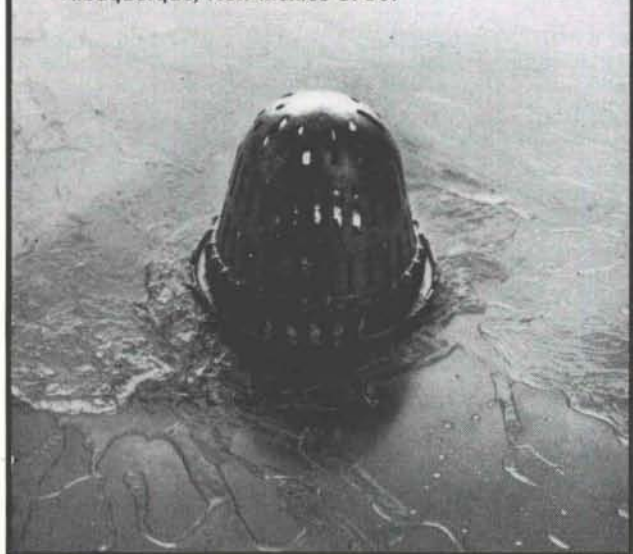

**FROM  
CONCEPT TO  
COMPLETION**



Exclusive distributors for **TAYLOR**

**Consultation  
Planning  
Design  
Layout**

Criteria, skill, artistry and experience are fused to produce laboratory furniture meeting the most exacting requirements of contemporary science educators and architects. Units immediately available and within the reach of any school or institutional budget.

Architects use our design consultation services for:  
Science Labs / Offices / Artrooms / Dormitories /  
Libraries / Auditorium Seating / Home Economics  
Labs / Gymnasiums

**UNIVERSITY BOOK STORE  
ALLIED SUPPLY CO.**

2122 Central, SE  
Phone 243-1776  
Albuquerque, N. M.

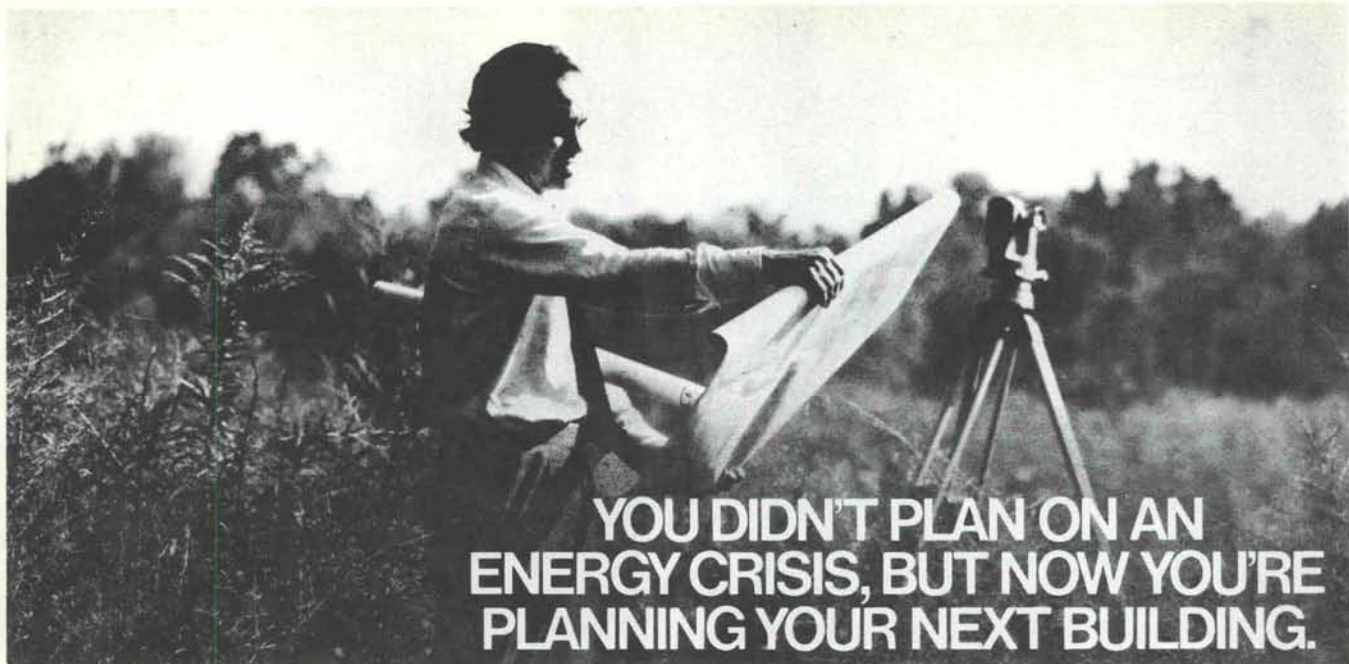

## YOU DIDN'T PLAN ON AN ENERGY CRISIS, BUT NOW YOU'RE PLANNING YOUR NEXT BUILDING.

Which building material will you use?

You've got energy shortages to think about. Air-conditioning costs. Heat gain through the long, hot summers. Heat loss in the winter months. Heating equipment costs. The whole set of energy-use factors suddenly has become critically important. The building material you use affects all of them.

Compare the energy conserving capability of masonry, for instance, with double-plate glass walls.

At 4:00 P.M. on a hot August day in Washington, D.C., the heat gain through a square foot of west-facing insulated brick and concrete block wall will be 2.2 Btus an hour.

The heat gain through a double-plate glass wall in the same location will be 173 Btus a square foot in an hour. A big difference.

Project this differential over 10,000 square feet of wall. You come up with a heat gain through masonry of 22,000 Btuh, while the heat gain through double-plate glass is 1,730,000 Btuh.

In the case of the masonry wall, cooling equipment with a two-ton capacity can handle the heat gain. But with the double-plate glass wall, about 143 tons of cooling capacity will be needed.

An analysis of a typical 10-story building shows that over its useful life, the air-conditioning cost for a square foot of our masonry wall will be about 23 cents. For the double-plate glass wall, it will be \$7.60.

It takes a lot of money to buy, install and create space for all the extra air-conditioning equipment

required by the double-plate glass wall. A lot of money and a lot of energy to run that equipment.

Compare the heat loss in winter. It has a dramatic effect on energy consumption and building operation costs.

Our masonry wall, for example, has a "U-value" of .12. The double-plate glass wall has a "U-value" of .55. (U-values are used to determine heat loss through one square foot of wall area in Btuh per degree Fahrenheit differential across the wall.)

This means that the masonry wall is about 450% more efficient, on the average, than the glass wall in reducing heat loss.

Over the useful life of the building, the heating cost per square foot of wall area for masonry will be about 30 cents. For double-plate glass, about \$1.38.

In a time of one energy crisis after another, masonry makes eminently good sense as a good citizen.

The masonry industry believes that the thermal insulating qualities of masonry are an important economic consideration to building designers, owners and investors, and all citizens.

Masonry walls save on air-conditioning and heating costs. And just as important, they are less expensive to build. The masonry wall we've described would have a 38% lower initial cost than the double-plate glass wall.

If you'd like to find out more, write to us and we'll send you a booklet comparing the thermal

insulating qualities of masonry walls with double-plate glass walls, metal panel walls and pre-cast concrete walls.

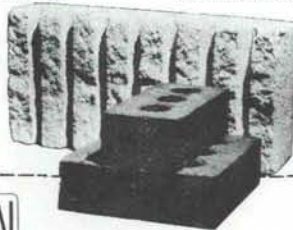

**International Masonry Institute**

823 15th Street, N.W., Washington, D.C. 20005

Please send the booklet comparing insulating qualities of masonry with other building materials.

Name \_\_\_\_\_

Title \_\_\_\_\_

Company \_\_\_\_\_

City \_\_\_\_\_

State \_\_\_\_\_

Zip \_\_\_\_\_

Nature of Business \_\_\_\_\_

**"MASON CONTRACTORS ASSOCIATION OF NEW MEXICO"**

## **AIA TAKES STAND ON TIMBER, SURFACE MINING**

Recent actions by the AIA have addressed two critical environmental issues: timber policy and surface mining.

In testimony presented before Senate and House subcommittees considering forestry legislation, Hugh B. Johnson, chairman of the Institute's Regional Development and Natural Resources Committee, called for establishment of a national forest management program.

Johnson stressed the inadequacy of existing measures to provide for efficient use and proper conservation of forest resources, calling the proposed legislation "only a beginning" toward the development of a comprehensive national program.

Johnson's testimony cited the need to insure better management of the federally-owned timber land not in the national forests and also recommended an augmented forestry incentives program that would encourage better management and production on privately-owned forest land.

The AIA also called for strict regulation of surface mining operations in a policy statement prepared by the Regional Development and Natural Resources Committee.

The statement outlines planning and environmental policies, placing special emphasis on strip mining which now accounts for 55 per cent of the nation's coal production.

Federal and state mining regulations, says the AIA, must provide for protection of water resources and insure that strip-mined areas can be returned to a stable condition for future use.

The statement recommends a systems analysis approach to planning for mining operations and land reclamation. Such planning would take into account not only ecological, geological, hydrological and engineering problems, but also the effect of strip mining on

## **New Mexico Arts Commission Announces 5th Awards Program**

Entries are now being solicited for the annual New Mexico Arts Commission awards program. The awards are given in two categories as outlined below:

### **1) "AWARD FOR EXCELLENCE" IN NEW CONSTRUCTION**

In order to recognize significant and distinguished contributions to the total environment, the New Mexico Arts Commission and the New Mexico Society of Architects have established an annual Award for Excellence for new or recent construction.

The award will be presented to designers of structures which have been built within the state of New Mexico, and which enhance the environment for Man.

### **2) "AWARD FOR EXCELLENCE IN THE" FIELD OF HISTORIC PRESERVATION**

It is an established fact that the retention of the historical records of man's achievement is of immense value to present and future generations. Historical buildings, artifacts, and sites are the visual catalogue of that heritage.

Accordingly, the New Mexico Arts Commission and the New Mexico Society of Architects have established an Award for

relevant regional plans and on the local physical, social, economic and esthetic environment.

The AIA encourages its members to become involved in the planning and analysis of surface mining as it relates to land and the environment, and advocates the inclusion of architects and other design professionals in all governmental advisory bodies concerned with the regulation of surface mining.

Excellence in the field of Historic Preservation. This award will recognize valuable efforts in the preservation of significant architecture, artifacts, or sites of historical importance. This award can be given to an individual or an organization who has made a significant contribution to the field of Historic Preservation.

The nominations for either award category are not limited to architect designed buildings. Any structure is eligible — a bridge, a dam, a house, a barn, a site, or a monument.

*Nominations are solicited from architects, engineers, planners, landscape architects, historical societies, garden clubs—any person or any organization.*

The New Mexico Society of Architects undertakes to administer these awards programs. The jury appointed by the New Mexico Society of Architects wants to see all that has been constructed or preserved throughout New Mexico which might warrant consideration for these awards.

No rules or restrictions are placed upon the presentation of entries. It is nominations which are solicited, not expensive and elaborate brochures. However, sufficient pictorial and documentation material must be submitted to explain the nomination to the jury.

*The Deadline for Receipt of Nominations is August 1, 1974. Send to any member of the Jury:*

*Van Dorn Hooker, Chairman  
Box 18, U.N.M. Station  
Albuquerque 87106*

*Earl P. Wood  
Plaza Luisa  
Santa Fe 87501*

*Beryl Durham  
514 North Canal  
Carlsbad 88220*

## SOLAR ENERGY BUILDING FOR N. M. S. U. W. T. HARRIS & ASSOCIATES — ARCHITECTS



The proposed new 24,520 sq. ft. State Department of Agriculture building complex at New Mexico State University, Las Cruces, New Mexico, designed by W. T. Harris and Associates, Architects, of Las Cruces and Hobbs, will feature the use of solar energy for heating and cooling of the structure. Bridgers and Paxton of Albuquerque are the mechanical engineers for the project.

Mr. Will Harris of the local firm, and Mr. Frank Bridgers, who is a widely recognized authority on the application of solar energy to beneficial use, state that they believe this will be the first major building in the world to be both heated and cooled by solar energy.

This solar heating and cooling system will deplete only twenty-one percent as much energy as would a conventional system. Annual energy cost savings, over a conventional heating and cooling system, based on 1973 rates, has been calculated to be \$2,535.00 and based upon estimated 1990 rates would be \$5,308.00 per year.

Mr. Harris states that the solar collector panels—7,000 sq. ft. of them—will be roof mounted and integrated with the building design.

Solar energy will be used to heat the water which flows through the metal collector panels. The panels will be covered with glass on the front, and insulated on the back.

A pressurized water tank will be used to store the 200° F. minimum temperature of water needed for summer cooling. This heated wa-

ter will be used to operate two absorption type chiller units. The 35,000 gallons of stored heated water is designed to operate the system for four consecutive cloudy days without additional solar input.

A small gas-fired boiler will supplement the solar collectors on a standby basis, on those rare days when the solar input is inadequate.

A central fan system will distribute hot and cold air to various portions of the building. The heat recovery system will use the internal area daytime heat in the building, as generated from lights and people, to heat the perimeter areas of the building when required. This allows the stored water temperature to be built up for night time use. When on the cooling cycle, the internal heat will be rejected through the absorption chillers to a conventional cooling tower located outside the building.

The concept of heating and cooling the new building by solar energy was approved by the New Mexico State University Board of Regents on January 7th. Besides the practical advantages of a clean, economical energy source, N. M. S. U. President Gerald W. Thomas said the regent's action in approving the solar units system would have a symbolic value. "It will effectively demonstrate to the nation the rightful leadership role of New Mexico both in research and the application of solar energy," he said.

## GHOST TOWN CONFERENCE TO BE HELD IN BOISE, IDAHO

A Ghost Towns and Mining Camps Conference co-sponsored by the National Trust for Historic Preservation, Rocky Mountain Arts and Humanities Foundation, Idaho State Historical Society, and Idaho Preservation Council will be held Friday and Saturday, May 31 and June 1, 1974 in Boise, Idaho. This is the first regional conference of its kind, isolating the specific problems of preserving western ghost towns and mining camps.

In announcing plans for the conference, the National Trust noted that one of the country's leading experts on the preservation of wood, Dr. Joe W. Clark, of the U.S. Forest Products Laboratory in Madison, Wisconsin will participate. Other sessions will include discussions of the legal problems of preserving abandoned and near abandoned towns, fire detection and prevention, fund-raising, new uses for old towns, and documentation and interpretation of ghost towns.

John L. Frisbee, Western Field Service Representative of the National Trust, added that "the problems of trying to preserve remnants of our historic western towns are complex. We hope that this will afford an opportunity for individuals and organizations from throughout the West to meet and discuss ghost town preservation problems. Hopefully, useful approaches to these problems will result." Sessions will be held in the Idaho State Historical Museum and the Boise Public Library. A post-conference tour on Sunday to Idaho City will offer participants a chance to see many preservation techniques that would be applicable to ghost towns.

For further information, contact the Western Regional Office, National Trust for Historic Preservation, 802 Montgomery Street, San Francisco, California 94133. Telephone: (415) 989-6428.

## THE GAVIN HOUSE IN SANTA FE

MCHUGH, KIDDER, BURRAN & WRIGHT, ARCHITECTS

NOTES BY JOHN MCHUGH, AIA



North Elevation

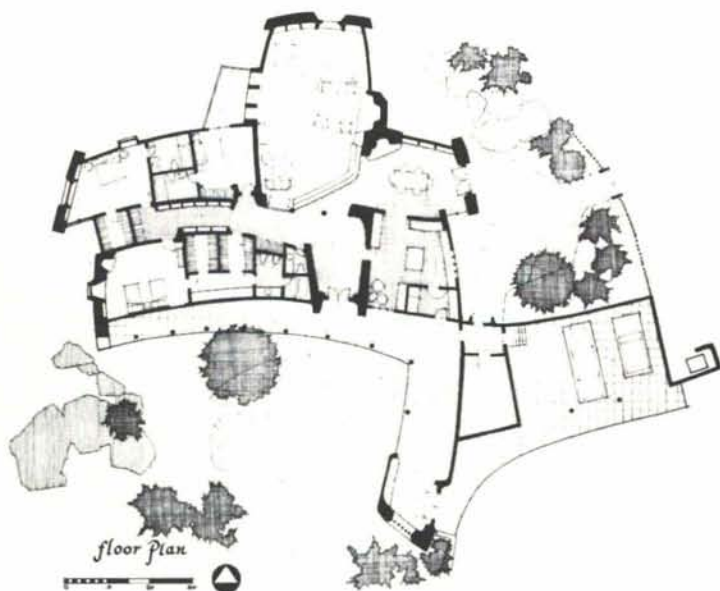

Floor Plan



South Elevation



East Elevation



West Elevation

It would be more accurate to revise the old saying, "An architect is as good as his client," to read, "An architect *may* be as good as his client"! Let us hope that we can, for the clients in this instance are very fine people, indeed. They have an inspirational site south-east of Santa Fe. Having given us a list of the spaces they need and the general sizes of these spaces, they then asked us to design a house that would be imaginative, graceful, and homey — something that would be appropriate to its time and its place and to the life that will be lived in and around it. On the ten-acre site we together chose a high spot on a ridge and fitted the house between two major and one minor rock outcroppings. The house was bent to conform to the terrain and to seize the views. These views are so powerful and dominating that it was decided not to open all of the rooms to them, but to aim different spaces toward different views and toward views of different magnitude.

We attempted to get a texture to the fabric: all the way from closed introverted spaces to larger more open ones; through porches, zaguans, and pergolas; there is a paved, fenced court, and finally the wide open south court facing the magnificent view down the valley to the Sandias. A series of stepped roofs and clerestoreys allow the light to penetrate so that the interior will be brought to life by the moving light of the sun.

We placed the living room at right angles to the main line of the house (and a few steps above it) to provide a variety of spatial interest. For in philosophy this house is far from Versailles. There is no magnificent axis nor intersection of axes where one should pause to appreciate the views. Here, one will appreciate the architecture from all points and at every moment while moving through it. We tried to follow Saarinen's advice of having the end always in view —but never final.—J. McH.



## San Vallé tile is forever.

### Time.

It takes time to create each piece of San Vallé genuine clay roofing tile.

We begin with three varieties of the finest quality clay. We blend it. Screen it. Then screen it again. We mill it. Mold it. Cut it to size. Then fire it at extreme temperatures.

It's a process we refuse to rush. That means fewer tiles produced, but it also means better tiles.

### Time.

The time we invest is repaid by an exceptionally durable tile whose rich natural or custom colors are permanently baked in and whose beauty actually increases as time goes by.

### Time.

We've been manufacturing clay roofing tile for seventy-five years. It was contemporary long before we started. And it still is.

**San Vallé** TILE KILNS

1717 NO. HIGHLAND AVENUE, LOS ANGELES, CALIF. 90028 • (213) 464-7289

THE NATION'S LARGEST PRODUCER OF GENUINE CLAY ROOFING PRODUCTS.

# AIA--1974--AIA

## The New Mexico Society of Architects

### OF THE AMERICAN INSTITUTE OF ARCHITECTS

President.....John P. Conron, FAIA/FAID	Director.....Ted C. Luna
Vice-President.....Richard Waggoner	Director.....Kenneth S. Clark, FAIA
Sec.-Treas.....Robert C. Campbell	Director.....Charles E. Nolan, Jr.
Director.....Jess T. Holmes, Jr.	Director.....Bill J. Waters
Director.....W. Kern Smith	Director.....Van Dorn Hooker

### ALBUQUERQUE CHAPTER A.I.A.

President.....Bill J. Waters	Director.....Chan Graham
President-Elect.....Eugene L. Hunt	Director.....Wayne G. Andrews
Secretary.....Loren Mastin	Director.....Jess T. Holmes, Jr.
Treasurer.....Joseph D. Long	

#### Fellow

Flatow, Max  
First Nat'l. Bank Bldg. East  
Suite #1600  
Albuquerque 87108  
268-6783

#### Corporate Members

Andrews, Wayne G.  
First Nat'l. Bank Bldg. East  
Suite #1600  
Albuquerque 87108  
268-6783

Armstrong, Robert F.  
3705 Westerfeld Drive, N. E.  
Albuquerque 87111  
294-8388

Barber, William G.  
2610 Monroe St., N. E.  
Albuquerque 87110  
255-2589

Barker, Hildreth L.  
8338 Comanche Rd., N. E.  
Albuquerque 87110  
296-4886

Benson, Harold R.  
P. O. Box 156  
Taos 87517  
758-2864

Boehning, Joseph F.  
2005 Carlisle Blvd. N. E.  
Albuquerque 87110  
268-8785

Bol, Andrew  
8338 Comanche Rd., N. E.  
Albuquerque 87110  
296-4886

Bolling, George H.  
First Nat'l. Bank Bldg. East  
Suite #1600  
Albuquerque 87108  
268-6783

Brittelle, W. Miles, Jr.  
3527 Hendrix Rd., N. W.  
Albuquerque 87107  
345-1148

Brown, Glynn  
10800 Menaul Blvd., N. E.  
Albuquerque 87112  
296-9409

Bryan, Garlan D.  
First Nat'l. Bank Bldg. East  
Suite #1600  
Albuquerque 87108  
268-6783

Burk, Christina  
512 Yale Blvd., S. E.  
Albuquerque 87106  
255-7537

Burk, William E. III  
512 Yale Blvd., S. E.  
Albuquerque 87106  
255-7537

Burwinkle, Joseph B., Jr.  
3209 Silver Ave., S. E.  
Albuquerque 87106  
268-9987

Campbell, C. Robert  
115 Amherst Dr., S.E.  
Albuquerque 87106  
255-8668

Campbell, Douglas A.  
3500 Indian School Rd., N.E.  
Albuquerque 87106  
266-5521

Cohlmeier, Robert C.  
4812 Madison Ct., N. E.  
Albuquerque 87110  
268-9112

Crawford, Dale L.  
3223 Silver Ave., S. E.  
Albuquerque 87108  
265-0986

Dekker, Arthur W.  
2609 Quincy, N. E.  
Albuquerque 87110  
256-3308

Della Longa, Joseph A.  
13532 Cedarbrook, N. E.  
Albuquerque 87111  
294-8533

Dysart, Cabot  
P. O. Box 1067  
Corrales 87048  
898-6629

Fanning, H. William  
4100 C Silver Avenue, S. E.  
Albuquerque 87106  
266-5874

Fernandez, Manuel A.  
4008 Pitt, N. E.  
Albuquerque 87110  
299-2839

Fletcher, Don  
103 Amherst, S. E.  
Albuquerque 87106  
266-4010

Fu, Yum Kee  
500 17th Street, N. W.  
Albuquerque 87104  
243-5939

Garcia, Lawrence A.  
1605 Carlisle, N. E.  
Albuquerque 87106  
255-7561

Gathman, Walter A.  
203 Truman St., N. E.  
Albuquerque 87108  
265-8329

Gilbert, Van  
300 Twelfth Street, N. W.  
Albuquerque 87102  
243-6162

Graham, Channell  
316 Val Verde Dr., S. E.  
Albuquerque 87108  
265-8791

Hesselden, Louis G.  
213 Fourth St., S. W.  
Albuquerque 87103  
243-4559

Holmes, Jess T., Jr.  
5905 Marble, N. E.  
Suite #10  
Albuquerque 87110  
256-9864

Hooker, Van Dorn  
Box 18, U.N.M. Station  
Albuquerque 87106  
277-2236

Hoshour, Harvey S.  
201 Coal Avenue, S. W.  
Albuquerque 87102  
242-3871

Hunt, Eugene L.  
201 Truman, N. E.  
Albuquerque 87108  
255-4864

Krueger, Donald  
1517 Girard, N. E.  
Albuquerque 87106  
268-6875

Krueger, Robert H.  
Bank of New Mexico  
Suite #1100  
Albuquerque 87101  
842-8663

Lake, Gerald H.  
601 San Pedro Dr., N. E.  
Suite #204  
Albuquerque 87108  
265-8452

- Long, Joseph D., Jr.  
8009 Mountain Rd. Pl., N.E.  
Albuquerque 87110  
265-5775
- Mallory, Robert G.  
115 Amherst Dr., S. E.  
Albuquerque 87106  
255-8668
- Mastin, Loren E.  
103 Amherst, S. E.  
Albuquerque 87106  
265-7103
- Moore, Jason P.  
First Nat'l. Bank Bldg. East  
Suite #1600  
Albuquerque 87108  
268-6783
- Neuner, August A.  
120 Vassar Dr., S. E.  
Albuquerque 87106  
265-5445
- Pacheco, Jesse A., Jr.  
316 Val Verde Dr., S. E.  
Albuquerque 87108  
265-8791
- Pearl, George C.  
115 Amherst Dr., S. E.  
Albuquerque 87106  
255-8668
- Ponto, Robert C.  
1030 San Pedro Blvd., N. E.  
Albuquerque 87110  
345-9477
- Predock, Antoine  
300 12th St., N.W.  
Albuquerque 87102  
243-6162
- Reed, John B.  
5905 Marble Ave., N. E.  
Suite #12  
Albuquerque 87110  
265-8505
- Rex, Allen M.  
8200 1/2 Menaul Blvd., N. E.  
Albuquerque 87110  
294-7200
- Ross, Leon A., Jr.  
First Nat'l. Bank Bldg. East  
Suite #1600  
Albuquerque 87108  
268-6783
- Rowland, James N.  
4125 Carlisle Blvd., N. E.  
Albuquerque 87110  
345-3603
- Sample, Jack  
6101 Candelaria, N. E.  
Albuquerque 87110  
255-8641
- Schlegel, Donald P.  
1620 Central Ave., S. E.  
Albuquerque 87106  
247-8558
- Shaffer, Donald M.  
First Nat'l. Bank Bldg. East  
Suite #1600  
Albuquerque 87108  
268-6783
- Shelton, Bill J.  
335 Jefferson St., S. E.  
Albuquerque 87108  
255-9690
- Stevens, Donald P.  
115 Amherst Dr., S. E.  
Albuquerque 87106  
255-8668
- Torr, Jerry R.  
10701 Lomas Blvd., N. E.  
Suite #201  
Albuquerque 87112  
298-7685
- Varsa, John P.  
903 Rio Grande Blvd., N.W.  
Albuquerque 87104  
242-5403
- Vogt, Leon O.  
2949 Wisconsin St., N. E.  
Albuquerque 87110  
299-7553
- Volz, Charles W.  
9424 Rio Grande Blvd., N.W.  
Albuquerque 87114  
767-7529
- Waters, Bill J.  
8009 Mountain Rd. Pl., N.E.  
Albuquerque 87110  
265-7557
- Weller, Louis L.  
335 Jefferson St., S. E.  
Albuquerque 87108  
255-9690
- Wendell, Wallace A.  
903 Rio Grande Blvd., N.W.  
Albuquerque 87104  
242-5403
- West, Donald L.  
Bordanaro Associates  
26415 Carmel Rancho Blvd.  
Carmel, Calif. 93940
- Wynn, George  
6303 Indian School Rd., N.E.  
Albuquerque 87110  
296-1772
- Associate Members**
- Armstrong, Rodney Lyle  
244 Aliso Drive, N. E.  
Albuquerque 87108  
256-7278
- Blair, Kenton William  
816 Palomas, N. E.  
Albuquerque 87110  
266-2650
- Bland, John C.  
201 Truman, N. E.  
Albuquerque 87108  
268-5240
- Boehning, A. W., Jr.  
2005 Carlisle Blvd., N. E.  
Albuquerque 87110  
268-8785
- Bornman, J. Carl  
4804 Ridgecrest Cir., S. E.  
Albuquerque 87108  
255-9078
- Boyle, Jack C.  
303 Morningside Dr., S. E.  
Albuquerque 87108  
256-9112
- Burns, William L.  
12300 Towner, N. E.  
Albuquerque 87112  
298-9183
- Cornwell, Allen B.  
1220 Fruit Ave., N. W.  
Albuquerque 87102
- Darby, Robert Paul  
5212 Mescalero Rd., N. E.  
Albuquerque 87112  
268-9161
- Dick, Deryl E.  
3817 Delamar Ave., N. E.  
Albuquerque 87110  
344-6827
- Fellows, Glenn N.  
530 Chamiso Lane, N.W.  
Albuquerque 87107  
898-0352
- Fullmer, Robert  
201 Truman, N. E.  
Albuquerque 87108  
255-4864
- Gafford, William R.  
7112 Edwina Court, N. E.  
Albuquerque 87110  
298-2588
- Gaskin, Frank Neal, Jr.  
3402 Indian School Rd., N.E.  
Albuquerque 87106  
268-3429
- Giaccardo, Marc A.  
2323 Kathryn, S. E.  
Apt. 521  
Albuquerque 87106  
255-2477
- Hall, Gordon  
636 San Pablo, N. E.  
Albuquerque 87110  
255-9218
- Hill, Ronald K.  
311 Fontana Place, N. E.  
Albuquerque 87110  
268-5980
- Hultzen, Peter  
1205 Princeton, N. E.  
Albuquerque 87106  
266-3931
- Johnson, John J., II  
212 Dartmouth, N. E.  
Albuquerque 87106  
268-6102
- McKinney, Joe C.  
608 17th Street, N. W.  
Albuquerque 87104  
242-4209
- Norris, Frank F.  
1021 Girard Blvd., N. E.  
Albuquerque 87106  
255-6926
- O'Brien, Ray  
3607 San Pedro Dr., N. E.  
Albuquerque 87110  
296-8603
- Pearson, Daniel Lee  
9401 Haines, N. E.  
Albuquerque 87111  
299-7810
- Ragsdale, Michael Butler  
203 Truman, N. E.  
Albuquerque 87108  
265-8329
- Richards, H. Scott  
619 Bryn Mawr Dr., N.E.  
Albuquerque 87106  
268-3797
- Robson, Thomas E.  
13408 Reo Rd., N. E.  
Albuquerque 87112  
293-1853
- Smith, Allan D.  
1408 Vassar, S. E.  
Albuquerque 87106
- Staples, Calvin E.  
14410 Geronimo Trail  
Reno, Nevada 89502
- Stubbs, Frank R.  
P. O. Box 4111  
Albuquerque 87106  
266-4484
- Professional Associate Members**
- Day, Stephen  
617 Luna Blvd., N.W.  
Albuquerque 87102  
247-3147
- Hooker, Marjorie M.  
P. O. Box 10149  
Alameda 87114
- Rocheleau, Robert L.  
9715 Euclid Avenue, N. E.  
Albuquerque 87112  
299-9057
- Wood, Arthur L.  
1316 Truman St., S. E.  
Albuquerque 87108  
255-2549
- Members Emeritus**
- Blumenthal, E. H.  
1621 Richmond Dr., N.E.  
Albuquerque 87106  
256-7977
- Burwinkle, Joseph B., Sr.  
3209 Silver Ave., S.E.  
Albuquerque 87106  
268-6077
- Ferguson, Gordon B.  
115 Amherst, S. E.  
Albuquerque 87106  
242-5030
- Hanneman, Eugene A.  
6008 Zimmerman Ave., N.E.  
Albuquerque 87110  
268-0716
- Jones, Warner H.  
526 Dartmouth Place, S. E.  
Albuquerque 87106  
255-3590
- Popkin, Charles A.  
1701 Cardenas Dr., N.E.  
Albuquerque 87110  
256-1009
- Selles, Malvin M.  
3050 S. Buchanan St. C-1  
Arlington, Va. 22206
- Springman, Raymond R.  
4414 Avenida Del Sol, N.E.  
Albuquerque 87110  
268-9100

## SANTA FE CHAPTER A.I.A.

Zip Code 87501

President.....Kenneth S. Clark, FAIA

Vice President.....Robert J. Strader

Director.....Ted C. Luna

Sec.-Treas.....John W. McHugh

Director.....John P. Conron, FAIA/FAID

### Fellows

Clark, Kenneth S.  
208 Delgado  
982-1951

Conron, John P.  
P. O. Box 935  
983-6948

Meem, John Gaw  
P. O. Box 1924  
983-6412

### Corporate Members

Buckley, Wm. R.  
P. O. Box 668  
983-6521

Girard, Alexander H.  
P. O. Box 2168  
983-6759

Halford, Richard  
321 W. San Francisco St.  
982-2621

Hyatt, Foster H.  
1579 Canyon Rd.  
983-7422

Kruger, Willard C.  
P. O. Box 308  
983-7308

Lattin, Eli Voil  
2071 North Road  
Los Alamos 87544  
662-4080

Lugton, C. R.  
659 W. Aberdeen Avenue  
Littleton, Colorado 80120

Luna, Ted C.  
225 E. Marcy  
982-8036

McHugh, John W.  
717 Canyon Road  
982-8556

Nestor, Robert L.  
717 Canyon Road  
982-8556

Patton, Charles D.  
P. O. Box 65  
Ute Park 87749

Quasthoff, Donna  
P. O. Box 2145  
827-2107

Register, Philippe deM  
P. O. Drawer "B"  
983-4333

Reisacher, Robert W. Col.  
522 Acequia Madre

Romero, Bernabe, Jr.  
N. Loop on Bower  
982-2123

Ross, Terrance W.  
225 E. Marcy  
982-8036

Stewart, Harold  
P. O. Box 1417  
983-6929

Strader, Robert J.  
717 Canyon Road  
982-8556

Torres, Reynaldo V.  
637 Cerrillos Road  
982-4911

Walker, Louis W.  
907 Camino Santander  
983-3274

Weidner, Urban C., Jr.  
Radio Plaza, Marcy St.  
983-4414

Wood, Earl P.  
Plaza Luisa  
983-4622

### Associate Members

Lester, Curtis  
P. O. Box 1742  
983-7592

Zamora, Robert  
1023 Dunlap  
988-2589

### Emeritus Member

Brunet, James A.  
P. O. Drawer "B"  
983-4333

## NEW MEXICO SOUTHERN CHAPTER A.I.A.

President.....Kern Smith

Vice President.....Wilbur T. Harris

Director.....Charles E. Nolan, Jr.

Sec.-Treas.....Joel Stout

Director.....Richard Waggoner

### Corporate Members

Alley, Rembert C., Jr.  
Room 414  
Hinkle Building  
Roswell 88201  
623-2132

Burrn, James A., Jr.  
Drawer J  
Clovis 88101  
762-2968

Dorsey, Duane  
Box 933  
Mesilla Park 88047  
523-4220

Durham, Beryl  
514 North Canal St.  
Carlsbad 88220  
885-5545 or 5640

French, Edwin C.  
P. O. Box 237  
Roswell 88201  
622-3851

Gorrell, Arthur A., Jr.  
510 West Fox  
Carlsbad 88220  
885-8500

Harris, Wilbur T.  
Drawer H  
Hobbs 88240  
393-5514

Hill, Jay  
Box 342  
Silver City 88061  
538-5601

Huber, Loran F.  
2505 Williams  
Clovis 88101  
762-1623

Killian, Richard L.  
Drawer H  
Hobbs 88240  
393-9743

Kilmer, Randall L.  
Drawer H  
Clovis 88101  
763-7124

Mitcham, Raymond  
Box 996  
Roswell 88201  
623-7111

Murray, James M., III  
South Broadmoor Building  
Hobbs 88240  
393-2561

Nolan, Charles E., Jr.  
Box 1788  
301 Eleventh  
Alamogordo 88310  
437-1405

Pendleton, Warren F.  
Suite 204, Studio City  
Clovis 88101  
763-6923

Pool, Sam  
Box 1788  
301 Eleventh  
Alamogordo 88310  
437-1405

Protz, D. Craig  
545 1/2 North Main  
Las Cruces 88001  
523-6194

Smith, W. Kern  
514 North Canal St.  
Carlsbad 88220  
885-5545 or 5640

Standhardt, Frank M.  
Arabella Route  
Box 24  
Tinnie 88351  
653-4442

Stout, Joel  
Box 1788  
Alamogordo 88310  
437-1405

Waggoner, Richard  
Room 414  
Hinkle Building  
Roswell 88201  
623-2132

Wham, Robert L.  
P. O. Box 672  
Hobbs 88240  
393-2880

---

The New Mexico Members of the  
**American Institute of Interior Designers**  
AND THE  
**National Society of Interior Designers**

**Fellows—AID**

Comeford, Modesta  
Modesta's  
3109 Central, N. E.  
Albuquerque 87106  
266-4884

Conron, John P.  
The Centerline, Inc.  
207 Lincoln Ave.  
Santa Fe 87501  
982-5674

**Members AID**

Branch, Eloisa Eckert  
Eckerts'  
3225 Central, N. E.  
Albuquerque 87106  
265-6966

Conkle, E. P., Jr.  
Modesta's  
3109 Central, N. E.  
Albuquerque 87106  
266-4884

Cox, Jessie  
Jessie Cox Interiors  
West Vineyard Lane  
Carlsbad 88220  
885-8318

Craig, William Dewey  
P. O. Box 218  
Alto 88312  
336-4626

Drew, Frank W.  
Drew-Pilat  
503 Canyon Rd.  
Santa Fe 87501  
983-4461

Duncan, Mary H.  
Eckerts'  
3225 Central, N. E.  
Albuquerque 87106  
265-6966

Fox, Ellen  
Ellen Fox Interiors  
1616 Boyita Lane, N. W.  
Albuquerque 87107  
344-1316

Grivas, Peter T.  
American Furniture Co.  
Carlisle & Menaul, N. E.  
Albuquerque 87110  
345-3331

Hamilton, Shirley M.  
Shirley Hamilton Interior  
3200 Fairway Drive  
Las Cruces 88001  
524-7164

Hockmuth, Renée L.  
d. r. h. Interiors  
3617 Copper, N. E.  
Albuquerque 87108  
266-7791

Huber, Jo Eckert  
Eckerts'  
3225 Central, N. E.  
Albuquerque 87106  
265-6966

Jones, Grady M.  
Interiors West, Inc.  
1020 East Lohman Ave.  
Las Cruces 88001  
524-7560

Nelson, Ronald W.  
4616 Robin, N. E.  
Albuquerque 87110  
266-3104

Paulick, Margaret  
Design Interiors, Inc.  
5021 Lomas Blvd., N. E.  
Albuquerque 87110  
268-4307

Pettingell, Jean  
212 Bryn Mawr, N. E.  
Albuquerque 87106  
268-7373

Pilat, Leonard  
Drew-Pilat  
503 Canyon Rd.  
Santa Fe 87501  
983-4461

Purdy, Wm. H.  
Bill Purdy Interiors  
400 South Sycamore  
Roswell 88201  
622-2858

Turrentine, Lynda  
Design Plaza  
Div. The Paper Mill, Inc.  
P. O. Drawer "P"  
Las Cruces 88001  
524-2866

Woods, Frank  
The Centerline, Inc.  
207 Lincoln Ave.  
Santa Fe 87501  
982-5674

Worthen, Richard G.  
American Furniture Co.  
Carlisle and Menaul, N. E.  
Albuquerque 87110  
345-3331

Zander, Emily V.  
Eckerts'  
3225 Central, N. E.  
Albuquerque 87106  
265-6966

**Members NSID**

Decker, Frank P.  
5915 Aspen, N. E.  
Albuquerque 87110  
256-3448

Felter, James D.  
Environment, Inc.  
3424 Central Ave., S. E.  
Albuquerque 87106  
265-1541

Ferguson, Catherine A.  
722 Solano, S. E.  
Albuquerque 87108  
843-6900

Garland, Jean  
Cignet Shop  
Swan Lake  
Espanola 85732  
852-4247

Nelson, Ronald W.  
4616 Robin Ave., N. E.  
Albuquerque 87110  
266-3104

Rusler, Lindsay  
P. O. Box 325  
Ruidoso 88345

Salazar, Rudolph  
Rudolph's Interiors  
3124 Central Ave., S. E.  
Albuquerque 87108  
265-6807

**Affiliate Members AID**

Gillespie, Johnnie Lou  
Design Interiors, Inc.  
5021 Lomas, N. E.  
Albuquerque 87110  
268-4307

Leo, Ernest  
American Furniture Co.  
P. O. Box 3685  
Albuquerque 87110  
345-3331

**Retired Members AID**

Rila, J. Norman  
Eckerts'  
3225 Central, N. E.  
Albuquerque 87106  
265-6966

**Press Associate AID**

Neff, Guy M.  
c/o Boca Studio  
619 Camino Rancheros  
Santa Fe 87501

**Education Associate AID**

Knapp, Patricia N.  
Cooperative Ext. Service  
Box 3AE  
New Mexico State University  
Las Cruces 88001

**Honorary Member AID**

Girard, Alexander H.  
P. O. Box 2168  
Santa Fe 87501

# James Murray III, AIA, brings Korean family to U. S. a saga:

-----through the thick, deep seas of bureaucratic red-tape to the dry, sunny shores of Hobbs, New Mexico

by:

James Murray III and Kang Chang Hwan

by:

James Murray III

In the spring of 1960, I was dispatched by the U. S. Government to the Land of the Morning Calm, Chosen, or Korea, as more popularly known. Ostensibly, my particular job was to be Commander of the 24th Ordnance Detachment (Explosive Disposal Control), which is normally a Major's job, but to which the Army, in its infinite wisdom, decided to dispatch a rather senior 1st Lieutenant, namely me.

Upon arrival, after various and sundry adventures and experiences in Japan, I discovered that my new command consisted of some twelve (12) Master Sergeants (each of whom had nearly as much time in the Army as I, in my innocent blush of youth, had years), and that I was not only C. O. of the 24th, but also was the Staff E. O. D. (Explosive Ordnance Disposal) Officer for Eighth Army, I Corps, 1st Cavalry Division, 7th Infantry Division, and 7th Logistical Command. This put me in direct responsibility for all explosive disposal in Korea, Japan, and several obscure small islands on both sides. Whew!! After a very brief adjustment period, it became apparent that operations would have to be re-organized. I did this, founding what later became known, (though not at Eighth Army, thank God!) as Murray's private Mafia.

This consisted of some 30 to 40 Koreans (I never could count them at one time) who assisted my people in unloading the trucks, stacking stuff in holes, placing explosives, and vanishing. They kept the demolition area exceptionally

clean, and kept outsiders and towns people away from the area, for the simple reason that they were policing up the scrap (after demolition) and selling it. I understand this was quite a good living at this time. We had a rather long list of applicants for membership in this somewhat exclusive group.

"Tommy," my Korean friend, had worked as a hired hand for the 24th for some time. He and another Korean named Ho Bong Cho, ran my Mafia for me. "Tommy" (Kang Chang Hwan) received his nickname because of regulations that prohibited giving Korean nationals *anything*. I began listing him on the morning report and ration report as Thomas Peabody, which was the best I could come up with at the time. We were policing up, rendering safe, and disposing of some 120 tons a month of unserviceable, out-dated, leftover, or flatly forgotten ammunition. Thus, with my twelve people and my Mafia, we were reasonably busy.

There seemed, at that time, to be a conspicuous tendency for anyone who had been in Korea to "forget," immediately upon arrival home, anything said or done in the Hermit Kingdom. Several persons, commanding officers and others, had promised this chap to get him to the States, and then—conveniently—had forgotten.

Tommy, I'm sure, was about to lose faith in the White Foreigner and all his wiles. I did not feel this was right. I took upon myself "the White Man's Burden," and told Tommy I would get him to



A photograph of the Kang family taken in Korea before they came to the United States. Kang Chang Hwan, his wife Chong Cha and son, Ki Man, arrived in Hobbs, N. M. early last year. The Kangs' adopted daughter, Hwang Eun Sil, age 19, is still living and working in Korea. "We are trying three different methods of getting her here—kidnapping, if that should prove necessary."

"I and my family are doing very well. My boy is doing fairly well in school, particularly in Math. He has some trouble with other courses, because of his English. He seems to have lost his manners, though. We have enjoyed it very much here." Kang Chang Hwan.

"We thank you and your country very much, Sir, and I am doing fine and have made many friends." Ki Man.

"Do bard mawiq opda." Chong Cha—"Kitty" (Kitty still doesn't speak much English, but it means, roughly, "I couldn't wish for anything more.")

the States. This was a promise. Little did I dream the ultimate consequences.

Parenthetically, "Tommy" has been with U. S. troops one hell of a long time, as evidenced by a copy of his original resume, which I am enclosing. This is what finally engendered his appearance on these shores.

The original plot was to bring Tommy here as a guest with the hope that red tape could be stretched far enough, given his arrival on these hallowed shores, to insure his citizenship. This was all but accomplished in 1961. Unfortunately, General Chung overthrew the government and took over some three months after I left. Writing off the some \$600-\$800, that I had spent at that point in bribes and "coaxing" money, we began again — our next try was to acquire him as a student.

Towards this endeavor several educational institutions contributed, but to no avail. Next, we attempted the gambit of getting him here as a guest — through me, personally, the Hobbs Rotary Club, the Seoul Rotary Club, and other reasonably recognized institutions—but again to no avail. The next avenue of approach was through Senator Joseph Montoya—who made quite sporadic efforts for some five (5) years. My next attempt (as you know, I'm rather stubborn) was with Congressman Harold Runnels, who took the trouble to *personally* read the file (quite lengthy at this point, i.e. 1½" thick with paperwork from sundry diplomatic types) and took this on, I think, as a real personal project. At any rate, an awful lot of red tape seemed to be slashed forthwith. There was one small boggle with a seemingly officious female dip-

lomat in Seoul, but Tommy tells me that once she received Harold's letter, there was a really miraculous change in her attitude.

All in all, it really has been a fairly arduous twelve (12) year process, but Tommy *and Wife and Kid* have arrived safe, sound, sober, and certainly far from sorry. Tommy is employed here, Ki Man (the Kid) is in school and doing quite well. We still have a problem in getting his adopted daughter here, but we're working on it.

If I may philosophize for a moment: some individuals are sometimes exceptionally fortunate—in that they are really able to be the instrument of help for other people or persons. I feel, certainly without any wish for aggrandizement or praise, privileged to be one of those people.

—J. M. III

Typical Correspondence:

24TH ORDNANCE  
DETACHMENT (EDC)  
APO 301  
San Francisco, California

24 October 1962

Mr. James M. Murray  
204 E. Mesa Dr.  
Hobbs, New Mexico

Dear Mr. Murray

The weather is now turning cold as winter approaches. Our work, as you know, is slowing down with the cold weather. We are buttoning up before the snow arrives.

It is going to take longer than I expected to get my papers in order, before I can come over. But I will not give up. When I was younger it was just a dream. But now with your help my dream is coming true. I have been told that a letter saying that you have the proper financial backing to support me, while on my "visit" will be needed. One of the men in the unit called this a credit reference. I hope this does not offend you in any way. But it is part of my getting permission to leave the country.

I am eager to meet your family and await each piece of news of my departure. I know that once I enter the United States, everything will turn out fine.

Once again I can't express my deep appreciation for all your help and encouragement in the things that means so much to me.

I hope that all is well with you and your family. Give my re-

gards to them, in fact, to all Americans and tell them I hope to meet them in person as soon as possible. Until then I will await your next letter.

Your friend,



P.S. Papasan and Korky say hello

... and nine years later.

October 6, 1971

Honorable Harold Runnels  
1127 Longworth Building  
Washington, DC 20515

Dear Harold:

A heart rending case has been brought to my attention by Jim Murray III, of Hobbs, in which he has literally tried to turn the world around and sent considerable money in an attempt to get a young Korean National to the United States.

Mr. Kang Chang Hwan, who was first adopted as a mascot by the 707th Ordnance Battalion of the 7th Infantry Division in Seoul, Korea in 1947. He was handed from one outfit to another as mascot for five years, at which time he received employment as a switchboard operator with the 226th Signal Detachment in 1952. Except for a brief holiday in this service he has been working for the United States government and still is to my knowledge with the 83rd Ordnance Battalion Ammo.

The reason for this short holiday in working for the government was his voluntarily quitting

his job in order to get severance pay to obtain a visa. This failed and he subsequently regained employment through assistance of loyal friends in the armed services in Korea.

His original application for passport and visa is shown to be October 26, 1960, and he has spent a small fortune in bribes and fees attempting to obtain authority for his coming to the United States.

After reading over the very voluminous file that Jim III has furnished one thing comes strongly to my mind as a possibility in which we may help. It was noted on several instances in the correspondence that an alien, after fifteen years of service on U. S. government payroll can be cleared on a non-quota basis to come to the United States with the help of his employer.

Please investigate these possibilities and any other possible avenue that Jim Murray III may be able to assist Mr. Kang in his untiring efforts to come to the United States.

Yours very truly,



Jim Denison  
Resident Congressional Aide

P.S. Harold, I am certain that Jim III will be able to furnish you with any substantiation of the case as well as his personal recommendation for this young Korean.

**EMBASSY OF THE  
UNITED STATES  
OF AMERICA  
SEOUL, KOREA**

Mr. Kang Chang Hwan  
#96 7 Tong 3 Bon  
Young Dong Po Ku  
Sihung Dong  
Seoul, Korea

13 July 1972

Dear Mr. Kang:

Reference is made to your application for special immigrant status under the provisions of Section 101 (a) (27) (E) of the Immigration and Nationality Act.

When the United States Congress created this special status, it was not intended to be conferred on employees or former employees of the United States Government merely as a recognition of fifteen years of service. The law specifically states that some portion of that service must have been rendered under "exceptional circumstances." Accordingly, there must be a showing of some special services performed during the qualifying fifteen year period which sets the employee apart from his colleagues. Examples of such special service could include employees who have fulfilled responsibilities beyond the call of duty such as: prevention of a physical attack on an American citizen; high quality work performance over an extended period of time or by the rendering of unusual service and assistance to the American community aside from his official duties.

Your documents have been carefully reviewed, and although the United States Government appreciates your long and faithful service, no portion of that

service can be considered to have been rendered under "exceptional circumstances." We have no alternative, therefore, but to deny your application. Your documents are returned for your records.

If you can submit concrete evidence of service rendered under "exceptional circumstances," we will be happy to review your application.

Sincerely yours,

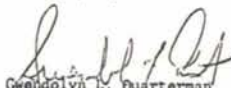
  
Gwendolyn L. Quarterman  
American Vice Consul

**CONGRESS OF THE  
UNITED STATES  
HOUSE OF  
REPRESENTATIVES  
WASHINGTON, D. C.  
20515**

July 24, 1972

The Honorable  
Gwendolyn L. Quarterman  
American Vice Consul  
United States Embassy  
Seoul, Korea

Re: Kang Chang Hwan

Dear Ms. Quarterman:

Mr. Kang has forwarded to me a copy of your July 13, 1972 letter to him.

In view of the reference to Mr. Kang's service under "exceptional circumstances," it occurred to me that perhaps the Embassy does not have on file a number of letters of recommendation and commendation certificates Mr. Kang has received.

Specifically, I refer to the following:

1. Florence I. Bloomberg, letter of December 2, 1971.
2. Stephen C. Zakrzewski, letter of December 1, 1971.
3. Walter W. Hudobenko, letter of November 29, 1971.
4. Harvey R. McDonald, letter of December 9, 1971.
5. Joseph A. Fields, letter of December 7, 1971.
6. Floyd A. Kittle, letter of December 1, 1971.
7. David L. Sims, letter of June 11, 1971.
8. John F. Coleman, letter of January 23, 1969.
9. Performance Award Certificates dated August 28, 1961; November 12, 1965; September 19, 1966; and November 14, 1968.

In addition, I am advised by Mr. Kang that this is not a complete list of his outstanding performance record.

It would appear that his service has been exceptional and this, coupled with the hazardous duty he performs as an Explosive Operator, would qualify him under the "high quality work performance over an extended period of time" contained in your letter.

Therefore, in view of the foregoing, I would appreciate knowing the basis of the Embassy's decision that Mr. Kang does not qualify for special immigrant status under the fifteen years' service provision.

Sincerely,

  
HAROLD RUNNELS, M. C.

**AND BY:**

**MR. KANG CHANG HWAN**

I was born December 6, 1938 in a village in North Korea. The name of the village I can no longer remember.

When I was very young my father left my mother and went to another village where he took another wife.

Until my mother died, she was the sole support for my elder brother and myself, my father had never returned to our village. When I was nine years old my mother died and it was necessary for my brother and I to go to my father's second wife's house so that we could be taken care of. Food was scarce in those times so my brother left home to look for a job since he was old enough to work. As for myself, I was too young to leave home, so I had to cut wood for the fire and help around the house every day.

My stepmother always found enough work for me to do, so I never got to go to school. Home life was a very unhappy period for me

since I had to work hard and still was not given enough to eat. My stepmother often incited my father into beating me and general maltreatment after I would leave home to go out and beg for food since I was given little or nothing to eat for days.

Early in 1948 I heard that my brother had crossed into South Korea to look for work and better living conditions. During this time anyone who crossed into South Korea, or tried to, was shot, but my brother had made it. By the time summer arrived I decided that I could no longer bear to live with my father and stepmother and the only person I could turn to for help was my brother, who at this time was said to be in Seoul.

After leaving home I walked for three days before I came to a bridge which was on the thirty-eighth parallel and my only way of entering South Korea. Crossing the bridge however, would not be a simple matter since there were three guards on the bridge with a machine gun. While they were talking to one another, I pretended to be playing and at the same

time I worked my way across the bridge. I then ran until I was totally exhausted and collapsed on the grass. Later I started asking for directions to Seoul from people who were passing by but they only laughed at me. Eventually I was able to get some directions and even a ride with some friendly people. On my fifth night after leaving home I arrived in Seoul and separated from the people who had given me the ride. Since I did not have any money for food I was told to go to the police station; they might give me some food. I went to the police station and told them who I was and why I had come south to Seoul. The policemen not only gave me some food but also let me sleep in the police station on a bench. In the morning one of the policemen woke me up and gave me some money and directions to No Rang-jin where my brother was said to be working in a watch repair shop. I rode a trolley car part of the way as the policeman had told me and walked part of the way in the direction I had been told. I stopped to buy

a meal of bread near a watch repair shop and as I was eating I saw my brother walking from house to house. I ran to him and after a joyous and tearful reunion he took me home with him.

Although conditions with my brother were better than they were at home with my father and step-mother I had to go out and look for a job since my brother's business was not very profitable. I found a job helping to make candy and selling it. That didn't last very long, since the business wasn't making enough money to pay for my help in room and board. As I was returning to my brother's house I saw my first American Compound. I had never seen an American before so I walked up to the gate and watched a Korean talking to some American GI's. After awhile the Korean man noticed me watching them and came over to me. He asked me where I was from and then how it was that I was there outside the compound. After I had finished my story the man gave me one hundred won. Until that time I had never seen one hundred won, never thinking that one day I would be given that much money. While I was rejoicing the man called me back to the gate and then took me onto the compound and to the mess hall where I was given sweet rolls to eat. Later I was taken to the gate and told to come back to the mess hall in the morning. In the morning I was again at the gate but there was a guard there also. The guard was the same one who had been at the gate the evening before when I was taken onto the post and he gave me an apple to eat. While the guard was talking to a truck driver who was going out of the gate, I walked through the gate and over to the mess hall where I found the man who had given me the food and money. He and his friends were the Korean mess help for the 44th Ordnance Maintenance Company and after stripping me and giving me a bath they said that they would take care of me. After five months how-

ever, the unit was sent to Japan and I had to remain behind.

The 707th Ordnance Battalion took over taking care of me after the 44th left for Japan until they too left for Japan three months later. When the 707th left for Japan three or four of the Americans decided to take me along with them. I was put into a "toko bag" and put on to a baggage truck which was going to the point of debarkation.

At the port I was carried on board the ship while still in the "toko bag." During the voyage, which lasted for three days, I was fed only crackers and water. On the ship I had been let out of the

Regiment. On either the 2nd or 5th of July, 1950, the 34th Infantry Regiment was sent to Korea and again I went with them.

They arrived in Pusan and fought their way to Taejon where their advance was stopped. Taejon was surrounded by the North Korean Army and they were closing in on the city when the Battalion Commander told me to leave the city by train with the wounded and some of the medics. At the train station, while the engine was warming up, four or five North Koreans arrived and started firing on the train wounding some more Americans. The train pulled out of the station while under fire from



bag but was put back in the bag for the train ride to Sindi, Japan. While on the trip I crawled out of the bag and was discovered by the company commanding officer.

The 707th was placed under the 7th Division and I lived with them for about a year. The Sergeant, who had been taking care of me at this time, was transferred to the 24th Infantry Division, 34th Infantry Regiment at Sasabo, Japan and I went with him. While my guardian was with the 34th Infantry Regiment I seem to have become the mascot for the entire

the North Koreans. Some North Korean soldiers ran to place charges on the railroad tracks to halt the train while we were leaving the yard but they were driven off by the fire put out from the train. At the next station we were told that we were the first to make it from Taejon alive. After that I stayed with the medics at the hospital until the Regiment split into the 19th Infantry Division and the 24th Infantry Division which went to Japan. The medics I was staying with were assigned to the 19th Infantry Division, and I stayed

with them until they were relieved by the 40th Division. When the 40th Division took over the area I was taken care of by them until early in 1953. During this time, Sergeant John Solyabe tried to get his parents to adopt me but the Special bill 5060 did not pass through Congress. Finally one of the Chaplains told me to go back behind the lines. After Sergeant Solyabe left Korea, I went south and found a job with the 226th Signal as a telephone operator. I worked there for five months at which time I met my first American Army E.O.D. (Explosive Ordnance Disposal) man and barely avoided being killed. I had been walking around for awhile one day when I saw an unusual looking metal item which I started to pick up. As I was about to touch it I heard a shout and was told not to touch it or it would kill me.

I later learned that this item was an American "Butterfly bomb" which either would explode on impact with the ground or when disturbed. The next day a team of E.O.D. men from the 19th Ordnance Detachment (EOD) arrived to take care of these deadly devices which were scattered throughout the area.

The Americans needed an interpreter for two days to work with them and I was picked for the job. At the end of the second day they had finished their job and asked me if I would like to work for them as an interpreter. It was also explained to me that I would have to work with explosives as well as act as an interpreter for them, if I accepted, which I did. I was taught how to handle explosives, various ordnance that was being found and what I wasn't to touch because it was too dangerous. One day a Master Sergeant was killed in another E.O.D. unit but I decided to continue to work with E.O.D. and their ordnance. At the end of the war the 19th Ordnance Detachment (EOD) was disbanded and I went to the 21st Ordnance Detachment (EOD). While I was working for the 21st Ordnance De-

tachment (EOD) I traveled throughout Korea with them disposing of hazardous ammunition and dangerous items.

In 1954 the 21st Ord. Det. (EOD) was disbanded and I was sent to the 15th Ord. Det. (EOD) in Seoul to work for them. I worked for them until the following year when they disbanded. This time I was sent to the 24th Ord. Det. (EODC). Again I was working in and around Seoul but this time with the 24th Ord. Det. (EODC). During the day I worked as an interpreter and in order to make more money I worked at night as the house boy for the 24th Ord. Det. (EODC). Over a period of time the number of people assigned to the 24th increased to the extent that I could make more money by working as a full time house boy than I could by being their interpreter, so I quit my job as interpreter and became a house boy. Whenever I had my work finished I'd usually go out on incidents with one team or another to work with them even though it wasn't part of my job. Later the size of the unit was decreased slowly so that by April of 1957 my job as house boy was no longer paying more than a job as an interpreter so I quit and became an Explosive Operator Junior Grade & Interpreter for the 24th.

Captain James Pew, who was the Commanding Officer for the unit, wanted to take me to the United States with him when he was to return there but while he and I were at our demolition range one day he had an accident. He picked up a 60mm mortar round which had been laying on the ground and started to examine it and then all of a sudden dropped it. The mortar round was filled with White Phosphorous and in picking it up he had opened up a crack in the shell casing which allowed the White Phosphorous to run out on his hand. I moved him away from the smoking W.P. mortar round since due to the size they burn down to their burster rapidly and when this happens they detonate. I gave him first aid as

best I could but he had to be taken to a doctor quickly. I drove him to the nearest Army Hospital, where he was to be a patient for the next two months. From the hospital he was sent to his home in the United States. Captain Pew was still trying to get me to the United States until 1961 when he died of a heart attack.

During 1957 the 24th Ord. Det. responded to about one thousand incidents and I was sent on most of them since I could interpret for them between the Koreans encountered and themselves. That year there were many people killed by ammunition, not only Koreans but also GI's.

In 1962, James Murray, a former Commanding Officer of the 24th Ordnance Detachment (EODC) 1960 invited me to fly to the United States and visit with him if I wanted to. I was delighted at the opportunity to visit with my old friend so I requested a six month leave of absence so that I would have an adequate time to make arrangements for my trip and the visit. After my request for a leave of absence was disapproved I resigned so that I could be free to visit the United States. In order to get a visa I was interviewed by the Consul of the American Embassy and during the course of the interview I was asked if Mr. Murray gave me a job would I be willing to remain in the United States to live. I told him that I would like that very much but the only way that I could live in the United States would be if I could bring my family to the United States too.

Later my request for a visa was denied. When Sergeant Major Hudobenko of the 24th Ord. Det. (EODC) heard about my denial for a visa he asked me to return to the service because he wanted me to help teach Korean soldiers Explosive Ordnance Reconnaissance which I had taught many times before. I worked for the 24th until 4 May, 1971, when I was transferred to the newly reactivated 7th Ord. Det. (EOD) in Taejon.

—KCH

## HANLEY PAINT

Serving the entire Southwest for over 36 years.

Ambassador Paints, finest quality interior protection.  
Sunfoe, climate-designed exterior paints.  
Old Pro, easy on, long-lasting paint products.  
Industrial-Technical Coatings, a full line of tough corrosion control systems.



new look of color  
COLOR QUAL ASSOCIATES

Hanley Paint  
Mfg. Co., Inc.  
Albuquerque, N. M.:  
1214 San Pedro N.E.  
El Paso, Texas:  
1531 Magoffin • 9054 Dyer •  
7636 Gateway East •  
5937 N. Mesa



# AGP

Home of the  
Concrete Giant!



DEDICATED TO QUALITY  
AND SERVICE

ALBUQUERQUE GRAVEL  
PRODUCTS COMPANY

600 JOHN ST. SE

Veri-Line  
LAYNE AND BOWLER

LAYNE AND BOWLER  
A SUBSIDIARY OF THE AURORA PUMP  
UNIT OF GENERAL SIGNAL  
200 NO PUENTE AVE. CITY OF INDUSTRY, CALIF. • P.O. BOX 1300 LA PUENTE, CALIF. 91741

ap  
AURORA PUMPS

# PUMPS

## VERTICAL TURBINE TYPE

Deep well—in line booster—fire—submersible—low head propeller

## CENTRIFUGAL TYPE

Condensate—end suction—fire—sump—split case—sewage

## VARIABLE SPEED PUMP SYSTEMS

Constant pressure, flow, level and temperature

REPRESENTED EXCLUSIVELY BY

# JAMES & COOKE, INC.

Albuquerque

(505) 256-3582

Spectra-Glaze®

GLAZED CONCRETE  
BLOCK WALLS . . . .

THE ECONOMIES OF BLOCK COMBINED  
WITH THE PERFORMANCE OF GLAZE

Build & finish in 1 operation. Thru-wall units, load-bearing or partition, eliminate cost of back-up walls. Permanent glazed factory finish. 1 trade, faster job, substantial savings.

Low maintenance. Cannot peel or blister. Impervious to moisture (even steam cleaning!) No refurbishing ever!

Resistance to chemicals. Acids, alkalis, solvents, disinfectants, etc.

2-face units available for lowest cost 2-face walls. Excellent insulation & sound-proofing.

4.5/Bu  
in SWEET'S



Many colors, scored & design faces available. Job-site delivery.

© Reg. U.S. Pat. Off., Canada & other countries by the Burns & Russell Co.

FEATHERLITE BLOCK CO., Box 489, Lubbock, Tex. 79408, 806/763-8202

FEATHERLITE BUILDING PRODUCTS CO., Box 9977, El Paso, Tex. 79990

BUILDERS BLOCK & STONE CO., INC., Roswell, N. M. & Albuquerque, N. M.

EMPIRE BLOCK CO., Santa Fe, New Mexico

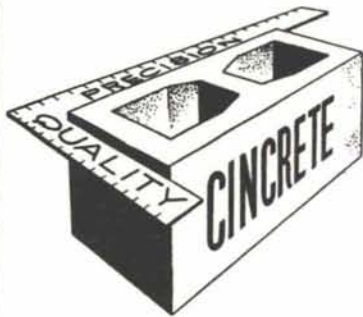

serving New Mexico  
and the El Paso area  
with

## Quality Concrete Masonry Products and many allied building materials



*Modernfold Wood and Plastic Folding Doors*  
*Hollow Metal Doors and Frames*  
*Steel and Formica Toilet Partitions*  
*Commercial Toilet Accessories*  
*Reinforcing and Fabricated Steel*  
*Commercial Hardware*  
*Moderncote Vinyl Wall Covering*  
*Residential and Commercial Steel and Aluminum Windows*

### Builders Block & Stone Co., Inc.

P. O. Box 1633  
Roswell, N. M. 88201  
505 622-1321

### Builders Block & Stone Co., Inc.

P. O. Box 10284  
Albuquerque, N. M. 87114  
505 265-6085

### Builders Block & Supply Co., Inc.

P. O. Drawer FF  
Las Cruces, N. M. 88001  
505 524-3633

### Builders Block & Supply Co., Inc.

Telephone  
El Paso  
915 532-9695

Members: New Mexico Concrete Masonry Association, National Concrete Masonry Association



## A R C H I T E C T S

There is no substitute for a good color coat stucco finish! However, a good color coat stucco finish depends on:

- The best materials
- Good building detailing
- Good specifications
- Proper application

We have the best stucco materials, which are specifically formulated for the Southwest and Rocky Mountain regions, and we can furnish you with the proper specifications. But only you can provide the proper detailing and close inspection to assure proper application.

Take advantage of the many unique textures and versatile applications of real color coat stucco—contact us for specifications and exciting new ideas.

*El Rey*

**STUCCO COMPANY, INC.**

4100 Broadway, S. E.  
Albuquerque, N. M.  
P. O. Box 6122  
505 877-7967

*Serving the architectural*

*profession - - - - professionally!*

**SANTA FE BUILDERS SUPPLY CO.**

SANTA FE

ALBUQUERQUE



NO JOB TOO LARGE—OR TOO SMALL  
ALMOST EVERYTHING IN ROOFING  
AND SHEET METAL

GOODRICH ROOFING IN  
ALBUQUERQUE FOR GOOD . . .

OUR CREDENTIALS . . . THOUSANDS OF  
SATISFIED CUSTOMERS

FREE ESTIMATES

(505) 345-1854

3402 Stanford Drive, N. E.  
ALBUQUERQUE, NEW MEXICO

*Happiness is having a good roof by Goodrich*



for over 50 years - - -  
from 1921

installed & serviced by

OVERHEAD DOOR COMPANY  
of ALBUQUERQUE

(505) 344-3467  
2840 LOS ARBOLES AVE., N. E. 87107



UNISTRUT

NEW MEXICO

METAL FRAMING  
TELESPAR TUBING

movable partitions

wire mesh partitions

toilet partitions

steel shelving and racks

4820 PAN AMERICAN HIGHWAY, N.E. • P.O. BOX 3128  
ALBUQUERQUE, NEW MEXICO 87110  
PHONE 505 345-2405

**PLASCO**  
INC. ALBUQUERQUE

mirror closet doors • shower  
doors & compartments • com-  
plete store front department  
patio doors • fiberglass shower  
stalls & tubs • plate glass  
mirrors • bathroom acces-  
sories • medicine cabinets  
screen & storm doors • glass  
& aluminum products • acrylic  
lavatories & tubs • complete  
screen service . . . . .

# OFFICE FURNITURE

- HERMAN MILLER
- KNOLL ASSOCIATES
- JENS RISOM
- AMERICAN DESK
- REPUBLIC STEEL DISTRIBUTOR
- ALL-STEEL EQUIPMENT

5021 Lomas Blvd., N.E.

Albuquerque, N. M.  
87110

268-4307



*design  
interiors, inc.*

PROFESSIONAL  
INTERIOR  
PLANNING

RETAIL &  
CONTRACT SALES

BUSINESS  
FURNITURE  
LEASING



**DISTINCTIVE OFFICE FURNITURE & UNUSUAL FURNISHINGS FOR THE HOME**

## ALBUQUERQUE TESTING LABORATORY

Sub-soil Investigations  
For Structural and Dam Foundations

**Two Drills and Crews now  
available for Prompt Service**

Laboratory Analysis and  
Evaluation of Construction Materials

**All work done under the supervision  
of Registered Professional Engineers**

532 Jefferson St. N.E. — P. O. Box 4101  
Phone AL 5-8916 Albuquerque  
Phone AL 5-1322 New Mexico

## ARCHITECTURAL SYSTEMS COMPANY

ACOUSTICAL CEILINGS  
BUILDER'S HARDWARE  
DEMOUNTABLE  
PARTITIONS

Box 3624  
Albuquerque  
345-3491

Earl A. Boule  
Gerald P. Shultz A.H.C.

## FLEX SHIELD

*waterproof flexible texture coating*

used on the exterior of the new

**J. Korber & Co. Building**

**2400 Menaul Blvd., Albuquerque**

Architect: Stevens, Mallory, Pearl & Campbell  
Painting Contractor: Keers, Inc.



Heavy texture coating for virtually all types  
of exterior and interior surfaces. Durable,  
waterproof, flexible.

**Wellborn PAINT**

Mfg. Company, Albuquerque, N.M. 877-5050



## ROCKY MOUNTAIN STONE CO.

*has moved to  
new and larger  
facilities - - - at*

**4741 Pan American Freeway N.E.  
Albuquerque, New Mexico 344-2611**

**Integrity and Beauty:  
The concrete facts of Southwestern life.**



Physics Laboratories and Lecture Hall on the University of New Mexico Campus  
Architect: Pacheco and Graham  
Structural Engineer: Robert Krause  
ChemComp Concrete supplied by Springer Corp.

When you want minimized shrinkage cracking for absolute structural integrity, durability and beauty, the concrete answer is ChemComp, Southwestern Portland's expansive cement. Check ChemComp's many advantages by writing for our free brochure: Box 392, El Paso, Texas 79943.



**SOUTHWESTERN PORTLAND CEMENT COMPANY**  
MAKERS OF EL TORO CEMENTS / EL PASO, AMARILLO, ODESSA

## new mexico architecture nma

Published bi-monthly by New Mexico Society of Architects, American Institute of Architects, a non-profit organization.

Editorial Correspondence should be addressed to John P. Conron, Box 935, Santa Fe, N. M. 87501. 505 983-6948.

Editorial Policy: Opinions expressed in all signed articles are those of the author and do not necessarily represent the official position of the publishing organization.

No responsibility will be assumed by the editor or publishing organization for unsolicited contributions. Return postage should accompany all unsolicited manuscripts.

Subscriptions: Write Circulation, New Mexico Architecture, Box 7415, Albuquerque, N. M. 87104. Single copy 50c. Yearly subscription \$2.50.

Change of address: Notifications should be sent to New Mexico Architecture, Box 7415, Albuquerque, N. M. 87104 at least 45 days prior to effective date. Please send both old and new addresses.

Advertising: Send requests for rates and information to New Mexico Architecture, Robert G. Mallory, 115 Amherst Drive S.E., Albuquerque, N. M. 87106. 505 255-8668.

Additional copies of NMA available from John P. Conron AIA/FAID, P. O. Box 935, Santa Fe, N. M. 87501.

PRINTED BY

HALL-POORBAUGH PRESS, ROSWELL, N. M.

**INDEX OF FIRMS** who make possible the publication of NMA and the page upon which their message may be found:

Albuquerque Gravel Products .....	22
Architectural Systems Co. ....	25
Albuquerque Testing Laboratory .....	25
Builders Block & Stone Co., Inc. ....	23
Century Roof Tile, Inc. ....	27
Cook's Building Specialties .....	4
Crego Block Co., Inc. ....	2
Design Interiors, Inc. ....	25
El Rey Stucco Co. ....	23
Goodrich Roofing Co. ....	24
Hanley Paint Mfg. Co., Inc. ....	22
Hydro Conduit Corporation .....	28
James & Cooke, Inc. ....	22
Keers, Inc. ....	6
Mason Contractors Assn. of N.M. ....	8
McGill Co., Inc., Geo. B. ....	4
Overhead Door Co. of Albuquerque ....	24
Plasco, Inc., Albuquerque .....	24
Prestressed Concrete Products, Inc. ....	6
Rocky Mountain Stone Co. ....	26
Santa Fe Builders Supply Co. ....	23
San Vallé Tile Kilns .....	12
Southern Union Gas Co. ....	5
Southwestern Portland Cement Co. ....	26
Southwest Vermiculite Co. ....	7
Spectra Glaze .....	22
Stryco Sales, Inc. ....	4
Summit Pressed Brick & Tile Co. ....	5
Unistrut New Mexico .....	24
University Bookstore .....	7
Wellborn Paint Mfg. Co. ....	25



# Glazed Concrete Roof Tile

Anything you can dream up on your drawing board, you can do with concrete roof tile. Anything.

Over-all patterns. Blends. Colors. Styles.

The ancient art of concrete roof tile has been changing. It's really a new technology with new versatility. New methods. New materials. Many of its applications today are truly innovative. If you've had the opportunity to talk with a roofing contractor recently, you have an idea of what we mean.

Your prospects will recognize it: that "something different" that will set their home, building, or project apart. Give it a distinctive personality that will express their individual taste. You can be as creative as you like. Glazed concrete roof tile is readily available locally from

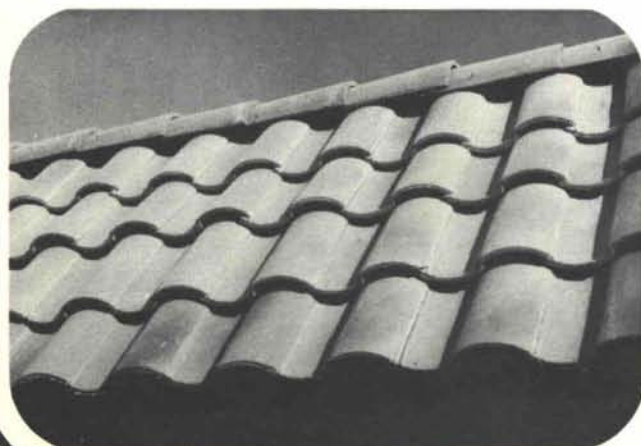

**Century**  
roof tile, inc.

*Write or call today for full details.*

130 Alvarado NE

Albuquerque, New Mexico 87108

**(505) 266-8601**

Van Dorn Hooker  
Box 18, University Station  
Albuquerque, New Mexico 87106

Bulk Rate  
U. S. Postage  
**PAID**  
Roswell, N. M.  
Permit No. 47

Vol. 16, Nos. 2 & 3

## **PRECAST CONCRETE . . . THE VERSATILE BUILDING EXTERIOR MATERIAL**



The new psychology building at the University of New Mexico was given a distinctive appearance of lasting beauty with precast concrete fascia panels with a unique sand blasted finish.

The three story building houses the Human Research Laboratories, the administrative portion of the Psychology Department and the Animal Research Laboratories.

There is a concrete roof deck for placement of cages and exercise of animals.

ARCHITECT—  
FLATOW-MOORE-BRYAN & FAIRBURN  
CONTRACTOR—  
BRADBURY & STAMM CONSTRUCTION  
CO., INC.



**HYDRO CONDUIT CORPORATION**

2800 SECOND STREET, SW - ALBUQUERQUE, NEW MEXICO 87103