

# TOM L. DARWIN

## COMPUTER PAYROLL SERVICES

WEEKLY PAYROLL - - -  
(5 - 500 EMPLOYEES)  
LABOR COSTS  
QUARTERLY REPORTS  
PAYROLL REPORTS  
W-2 FORMS

2622 SAN MATEO N. E. ALBUQUERQUE  
255-9093 87110

—OUT-OF-STATE INQUIRIES INVITED—

## new mexico architecture

nma

Published bi-monthly, by the New Mexico Society of Architects American Institute of Architects, a non-profit organization, Box 7415, Albuquerque, N. M. 87104.

Editorial Correspondence: All correspondence should be addressed to John P. Conron, P. O. Box 935, Santa Fe, New Mexico 87501.

Editorial Policy: Opinions expressed in all signed articles are those of the author and do not necessarily represent the official position of the New Mexico Society of Architects, A.I.A.

No responsibility will be assumed by the editor or publishing organization for unsolicited contributions. Return postage should accompany all unsolicited manuscripts.

Subscriptions: Write Circulation New Mexico Architecture, Box 7415, Albuquerque, N. M. 87104. Single copy 50c. Yearly subscription \$2.50.

Change of address: Notifications should be sent to New Mexico Architecture, Box 7415, Albuquerque, N. M. 87104 at least 45 days prior to effective date. Please send both old and new addresses.

Advertising: Requests for rates and information relating to advertising should be addressed to New Mexico Architecture, Box 7415, Albuquerque, N. M. 87104, or Rob't. G. Mallory, 115 Amherst Dr. S. E., Albuquerque, N. M. 87106.

# ChemComp doesn't shrink from any job.

When you want minimized shrinkage cracking for absolute structural integrity, durability, and beauty, the concrete answer is ChemComp, Southwestern Portland's expansive cement. ChemComp is finished cement, not an additive or partial replacement. It greatly reduces maintenance and repair costs due to cracks. It generally eliminates the need for waterproof membranes or surface sealants. Check ChemComp's many advantages.

WRITE FOR FREE BROCHURE:  
BOX 392, EL PASO, TEXAS 79943.



**SOUTHWESTERN PORTLAND CEMENT COMPANY**  
MAKERS OF EL TORO CEMENTS / EL PASO, AMARILLO, ODESSA

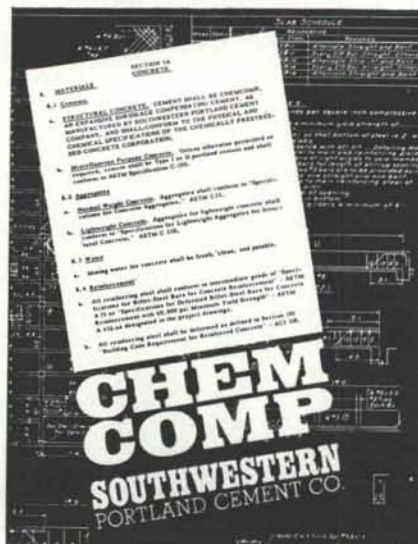

INDEX TO FIRMS cooperating in the public relation program of the NMA magazine, making possible its publication and the page upon which their message may be found.

Albuquerque Gravel Products Co.	4
Albuquerque Lumber Company	5
Architectural Systems Company	20
Albuquerque Testing Laboratory	20
Baldrige, J. C., Lumber Company	7
Builders Block & Stone Co., Inc.	6
Carroll, Bill C., Co.	20
Chateau Mill & Mfg. Co., Inc.	23
Concrete Systems, Inc.	8
Crego Block Co., Inc.	2
Darwin, Tom L.	22
Design Interiors, Inc.	23
El Rey Stucco Co.	21
Featherlite Building Products Co.	5
Featherlite Tile Company	7
Goodrich Roofing Co.	5
Hanley Paint Mfg. Co., Inc.	4
Hydro Conduit Corporation	24
James & Cooke, Inc.	4
Jaynes Corporation	21
Keyson Applied Coatings, Inc.	21
Kinney Brick Company, Inc.	21
McGill, George B., Co.	23
New Mexico Marble and Tile Co.	6
Prestressed Concrete Products Co.	14
Public Service Co. of New Mexico	14
Rocky Mountain Stone Co.	20
San Vallé Tile Kilns	18
Santa Fe Builders Supply Co.	20
Southwestern Portland Cement Co.	22
Southern Union Gas Company	7
Southwest Vermiculite Co.	8
Stryco Sales, Inc.	6
Unistrut New Mexico	4
University Book Store	18
Wellborn Paint Mfg. Co.	7



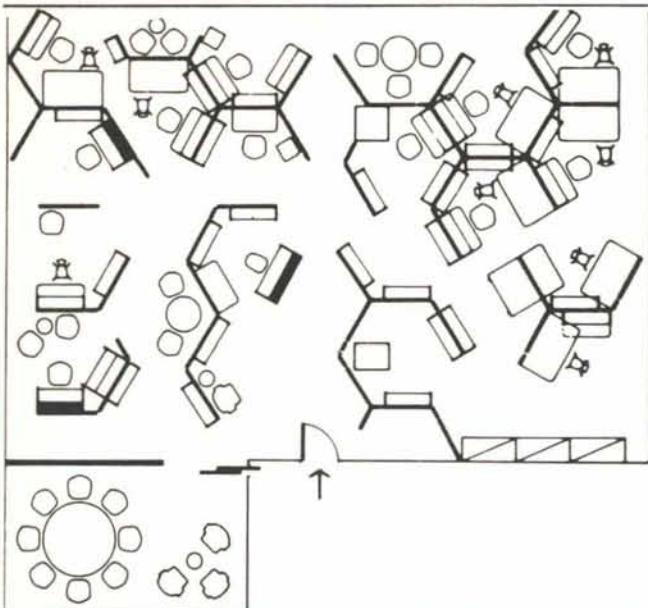

## People/Facilities/Change

Herman Miller's Action Office II is designed to save space, reduce total cost and increase personnel efficiency. It's a facility concept based on change. It welcomes change and includes it in its original design concept. Revolutionary? Yes. Yet it's a return to a common sense approach to the requirements of an office. You are invited to see AOII in action . . . contact John Campbell at . . .

design interiors, inc.

5021 lomas blvd. n. e.  
albuquerque, n. m. 87110  
telephone 505-268-4307

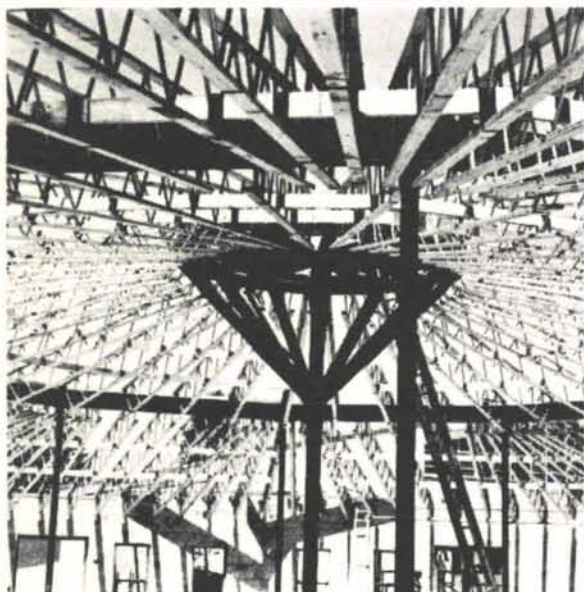

We've always thought of them as lightweight . . . long span . . . versatile . . . money-saving. But good looking? TRUS JOIST?

That's what they said.

Charles E. Nolan, Jr., AIA, writes: "... several school board members commented that if they had known the TRUS JOIST'S were going to look that good, they might have left them exposed. The job turned out very well."

Now we've heard everything.

Lightweight . . . long span . . . versatile . . . money-saving . . . GOOD LOOKING.

Now, you've heard everything.

Building: Cloudercroft Municipal School

Architect: Charles E. Nolan, Jr.

Contractor: Laub Contractors, Roswell



**George B. McGill & Company, Inc.**

210 Cagua Drive N. E.

Albuquerque

505/256-2058

**U.S. Plywood Sanspray®**

# Stone on plywood

**EPOXY AND AGGREGATE FACTORY  
PREFINISHED EXTERIOR PLYWOOD PANELS—  
WITH THE MUSCLE OF PLYWOOD AND THE  
LONG-LASTING DURABILITY OF STONE!**

now stocked and distributed by

**Chateau Mill & Mfg. Co., Inc.**

**CABINETS    FIXTURES    MILLWORK**

**Albuquerque, New Mexico (505) 345-1991**



Van Dorn Hooker  
Box 18, University Station  
Albuquerque, New Mexico 87106

Bulk Rate  
U. S. Postage  
**PAID**  
Roswell, N. M.  
Permit No. 47

Vol. 13, Nos. 11 & 12

## PRECAST CONCRETE EXPOSED AGGREGATE PANELS



### Chosen for New Albuquerque Post Office Complex

The recently constructed U. S. Post Office and Vehicle Maintenance Facility at Albuquerque features precast concrete exposed aggregate exterior walls for minimum maintenance, maximum fire resistance and security. Of New Mexico Travertine stone aggregate, the panels average 5' 4" x 30'. Hydro Conduit also fabricated the striated precast concrete fascia panels for the over 100,000 square foot structure. Designed to conform with the U. S. Post Office Departments' "excellence of design" program, the exposed aggregate panels gave the structure maintenance-free beauty and long life.

#### ARCHITECT

W. C. KRUGER & ASSOCIATES  
ARCHITECTS • ENGINEERS • PLANNERS

#### GENERAL CONTRACTOR

BRENNAND CONSTRUCTION CO.  
SANTA FE

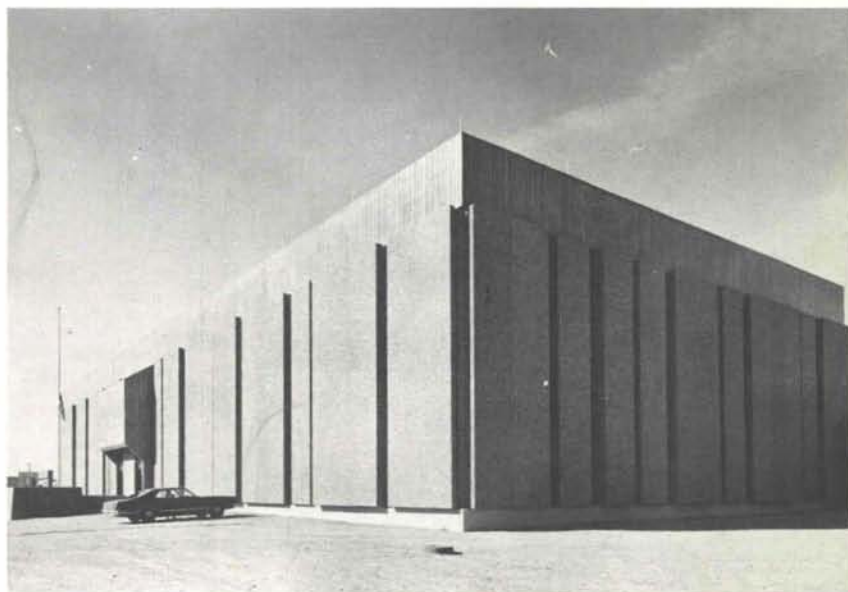

**HYDRO CONDUIT CORPORATION**

2800 SECOND ST., SW • ALBUQUERQUE, NEW MEXICO 87103