

Based on Map Sheet 15 of the Rio Pueblo de Taos Hydrographic Survey

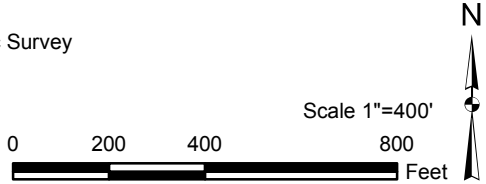

STATE OF NEW MEXICO
 Office of the State Engineer
 John R. D'Antonio Jr., P.E., State Engineer

Rio Pueblo de Taos & Rio Hondo Adjudication
 RIO PUEBLO DE TAOS SECTION

**On Pueblo Points of Diversion
 for the
 Acequia Madre de la Loma
 del Ranchito de Abajo**